

Return To:

Pool Warehouse

Phone\Fax: 1-800-515-1747

DEALER IS RESPONSIBLE FOR THE PROPER FIT!

By the submission of this order, the below named corporation and individual hereby authorize HYDRA POOLS to manufacture as a special order, a vinyl liner for an inground pool in accordance with the design and specifications which have been provided here within, and hereby acknowledge that HYDRA POOLS has not participated in either the design or formation of this liner and accepts full responsibility for the same, and further agrees to hold HYDRA POOLS harmless, that is, the below named corporation will pay in full or for any and all claims and expenses that may arise out of the design or use of this special liner.

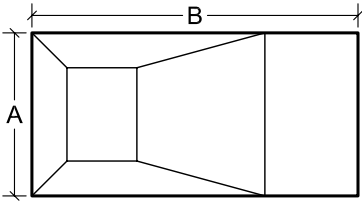

RECTANGLE
Radius Hopper
Corners

INCH RAD.

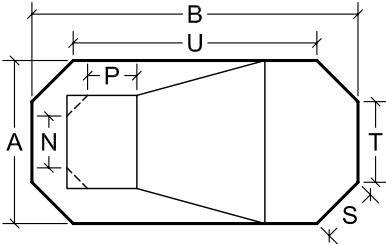

GRECIAN
Hopper Shape
 Contour
 Square

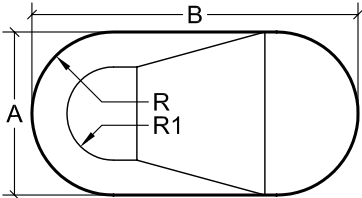

OVAL
Hopper Shape
 Contour
 Square

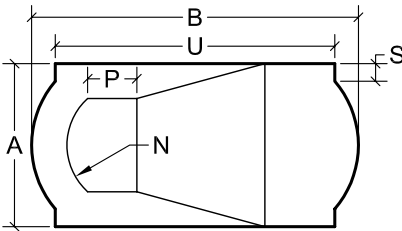

ROMAN END

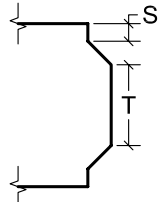

BOWED END

SELECT POOL CORNER TYPE

SQUARE

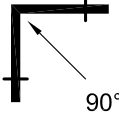

90°

RADIUS

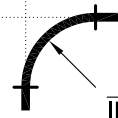

INCH RAD.

DIAGONAL

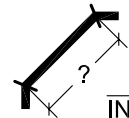

INCH DIAG.

Company: _____

Address: _____

CITY _____ STATE _____ ZIP _____

Phone: () _____

Ordered By: _____

PO # _____

Date: _____

SHIPPING INSTRUCTIONS

Company: _____

Address: _____

CITY _____ STATE _____ ZIP _____

Phone: () _____

Mark Box: _____

Ship Via: _____

FINISHED DIMENSIONS

A _____	G _____	J _____	R _____
B _____	H _____	K _____	R1 _____
D _____	I _____	L _____	S _____
E _____		M _____	T _____
F _____		M2 _____	U _____
SAFETY LEDGE _____			N _____
COVE OFFSET _____			P _____
COVE DEPTH _____			

Is the Pool Bottom 'BOWLED' or 'DISHED' out? _____
If 'YES', supply additional drawings representing the bottom design.

IMPORTANT!

BEAD

- Yes No _____ in. overlap
- Reverse Esther Williams (large bead)

PATTERN

Wall Pattern: _____

Floor Pattern: _____

Vinyl Thickness: 20 Mil 27 Mil 30 Mil

Total Square Footage: _____

DRAWING NUMBER: _____

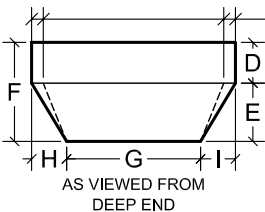

AS VIEWED FROM DEEP END

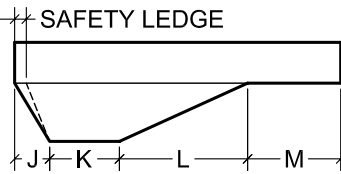

SPORT-BOTTOM POOLS

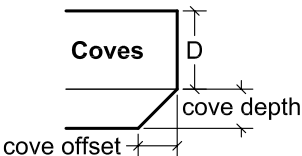
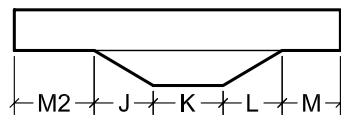

Coves

cove offset

ADDITIONAL INFORMATION ON BACK? Yes No

SOME POOLS ARE NOT BUILT TO MANUFACTURERS SPECS. IT IS IMPORTANT THAT YOU VERIFY THE DIMENSIONS

HYDRA POOLS and its authorized distributors and dealers, as part of the swimming pool industry and members of the Association of Pool and Spa Professionals adopt those standards for the purpose of pool safety to prevent the risk of a consumer or guest from suffering a severe or paralyzing injury or loss of life due to diving into water less than prescribed by modern standards. Such injuries can also occur by sliding head first into shallow water. We will produce the liner according to the dimensions provided only upon the following conditions -

The consumer recognizes that the pool may be of a nonconforming type and:

1. Consumer agrees to permanently remove the diving board if it exists prior to the installation of this liner.
2. Consumer agrees to relocate sliding board if necessary, prior to installation of this liner, to conform to APSP standards.
3. Consumer agrees to defend, indemnify and hold HYDRA POOLS and its distributors and dealers harmless from any claims arising from injuries that may occur from the use of the pool containing this liner.
4. Consumer agrees that in addition to abiding to the conditions above, he will not allow use of the pool by anyone, including guests, which is inconsistent with this warning.

I UNDERSTAND THE ABOVE WARNING AND RECOMMENDATIONS, CERTIFY THAT I WILL ABIDE BY ALL PERTINENT CONDITIONS, AND REQUEST THAT YOU PRODUCE THIS LINER AS ORDERED.

YOU MUST SIGN AND RETURN THIS FORM WITHIN 2 BUSINESS DAYS OR IT WILL NOT BE PROCESSED.

Pool Owner Signature _____

DATE _____