

18' X 36'6¹/₄" MOUNTAIN POND RIGHT

ACCEPTED BY	
DATE	
PURCHASE ORDER	

A	18'	K	6'
B	36'6 ¹ / ₄ "	L	12'
D	3'4"	M	14'6 ¹ / ₄ "
E	3'8"	M2	-
F	7'	T	-
G	10'	S	-
H	4'	N	-
I	4'	P	-
J	4'	U	-

APSP TYPE	0	SQ. FOOTAGE	738
-----------	---	-------------	-----

QTY	PART	DESCRIPTION
1	HP505	5' PANEL
1	HP503	3' PANEL
1	HP502	2' PANEL
1	HP501	1' PANEL
1	HP862	17 ¹ / ₂ " CUSTOM PANEL
1	HP862	1' X 08 ³ / ₄ " 129° CUSTOM PANEL (A)
10	HP359	9R PANEL
1	HP359LL	9R PANEL (LIGHT)
1	HP359A	9R PANEL (A/G)
2	HP110D	(9R) 2' OVAL INSERT
8	HP319N	9R REVERSE
30	HP599	BRACE
1	HS106N	RADIUS 8' STEP

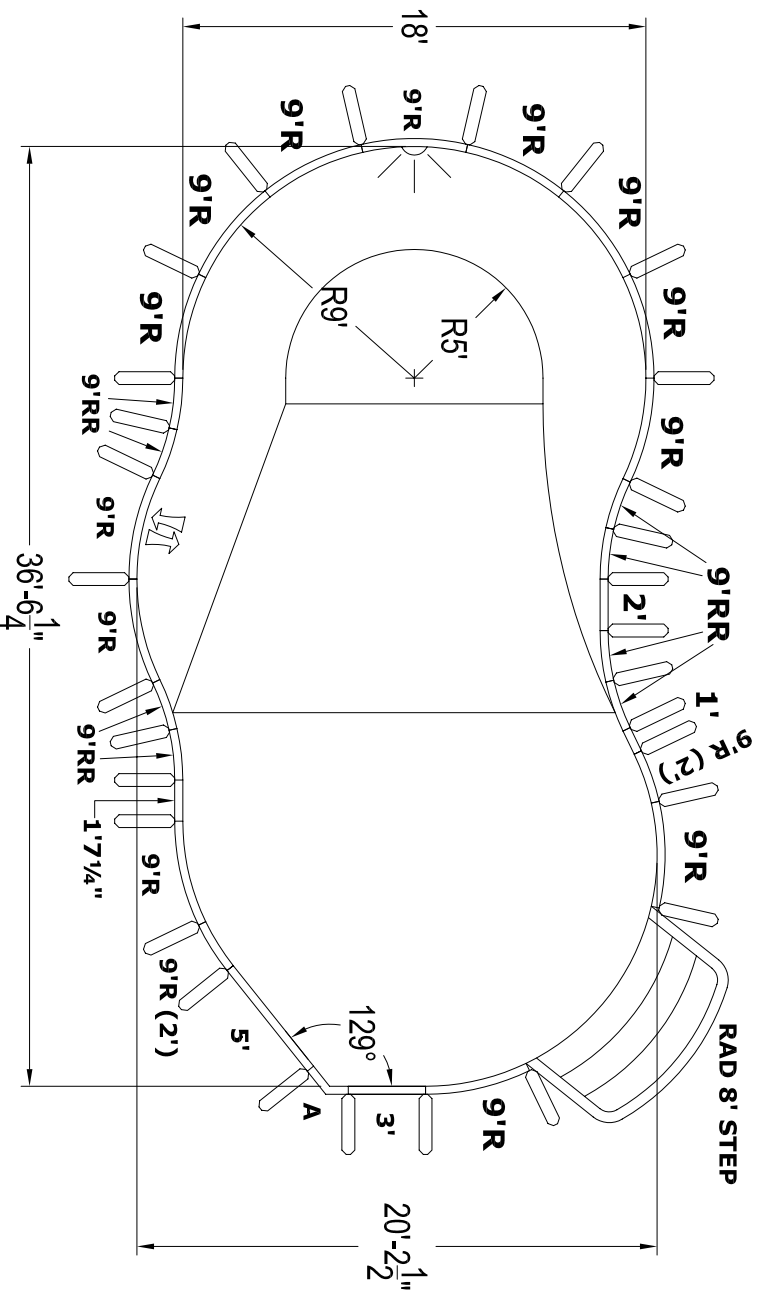
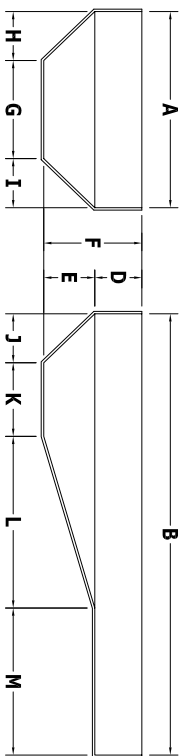

PANEL SHELF DETAIL

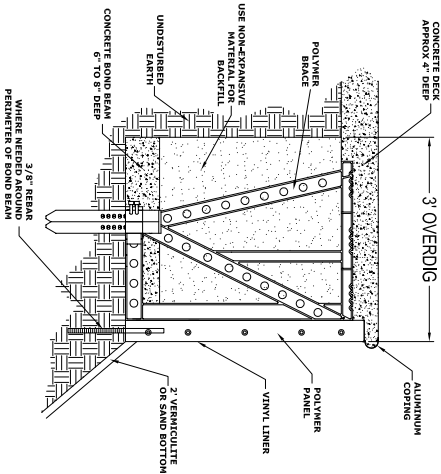

NO DIVING WARNING

NO DIVING WARNING STICKERS MUST BE INSTALLED IN NO DIVING AREAS ACCORDING TO APSP SPECIFICATIONS



PRE-CUT PANEL LEGEND



GENERAL NOTES

1. These are finished dimensions ready for the liner.
2. Dimensions are from inside pool panels.
3. The water level should be no more than 6" below the coping receptor (hangtab) slot.

EXCAVATION NOTES

1. Rough excavation should be 2" to 3" deeper in each instance.
2. Soil to have minimum bearing capacity of 2000 P.S.F.
3. Locate top of pool at least 6" above surrounding land elevation.
4. See Panel Shell Detail for excavation around pool.
5. Fill voids under base of panels and lamp well.
6. Backfill with non-expansive material.

ADDITIONAL NOTES

THIS DOCUMENT IS FOR ILLUSTRATIVE PURPOSES ONLY. The dealer or contractor who sells or installs your pool is an independent contractor and is not an agent of the Manufacturer. The construction methods illustrated here are suggestions and apply only to normal ground conditions. There may be additional precautions and/or methods of construction. Proper installation is the responsibility of the dealer/distributor/contractor.

DATE	MAY 2006
PANEL LINE	PINNACLE
DRAWING NUMBER	IMPR18369R7P



543 South Main Street - Sweetwater, TN 37874