

17'5³/₄" X 39'6¹/₄" X 23'7³/₄" OASIS

ACCEPTED BY

A	17'5 ³ / ₄ "	K	6'
B	39'6 ¹ / ₄ "	L	14'
D	3'4"	M	15'6 ¹ / ₂ "
E	4'8"	M2	-
F	8'	T	-
G	9'5 ³ / ₄ "	S	-
H	4'	N	-
I	4'	P	-
J	4'	U	-

NSPI TYPE

II

AREA

935

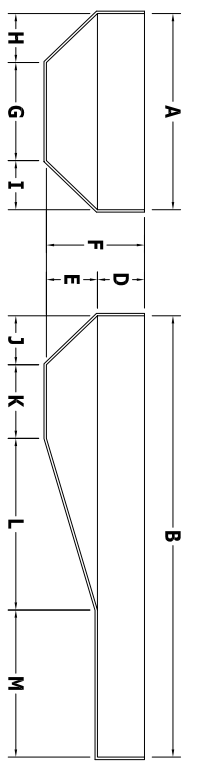

PURCHASE ORDER

DENHAM

QTY	PART	DESCRIPTION
2	HP306	6' PANEL
1	HP304	4' PANEL
1	HP304L	4' PANEL (LIGHT)
1	HP302	2' PANEL
2	HP301	1' PANEL
2	HP382S	16" SPECIAL PANEL
10	HP369	9R PANEL
2	HP359A	9R PANEL (AG)
5	HP119M	9R REVERSE
2	HP321	30° LAZY-ELL PANEL
2	H01576	45° WEDGE
5	HP126	5° WEDGE
29	HP599	BRACE
1	HS107N	STRAIGHT 8' STEP

BILL OF MATERIALS

PANEL SHELF DETAIL

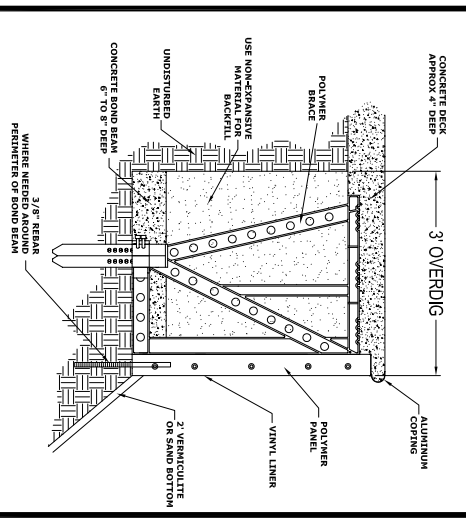

NO DIVING WARNING
NO DIVING WARNING STICKERS MUST BE INSTALLED IN NO DIVING AREAS ACCORDING TO NSPI SPECIFICATIONS



PRE-CUT PANEL LEGEND

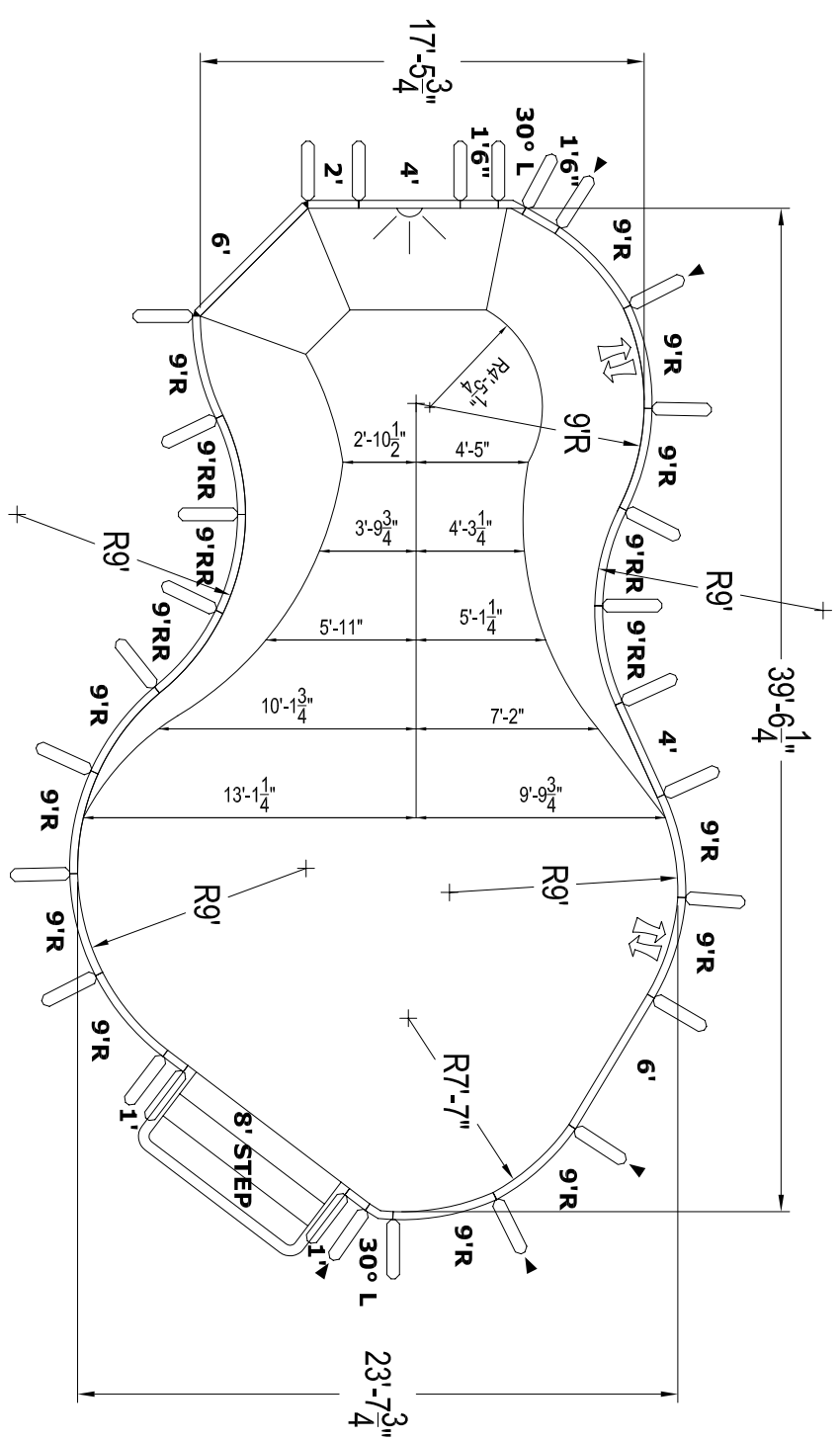
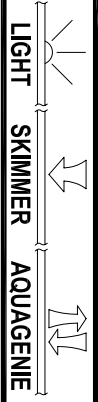

GENERAL NOTES

1. These are finished dimensions ready for the liner.
2. Dimensions are from inside pool panels.
3. The water level should be no more than 6" below the coping receptor (hangab) slot.

EXCAVATION NOTES

1. Rough excavation should be 2" to 3" deeper in each instance.
2. Soil to have minimum bearing capacity of 2000 P.S.F.
3. Locate top of pool at least 6" above surrounding land elevation.
4. See Panel Shell Detail for excavation around pool.
5. Fill voids under base of panels and lamp well.
6. Backfill with non-expansive material.

ADDITIONAL NOTES

THIS DOCUMENT IS FOR ILLUSTRATIVE PURPOSES ONLY. The dealer or contractor who sells or installs your pool is an independent contractor and is not an agent of the Manufacturer. The construction methods illustrated here are suggestions and apply only to normal ground conditions. There may be additional precautions and/or methods of construction. Proper installation is the responsibility of the dealer/contractor.

DATE: FEB 2006
PANEL LINE: CORNERSTONE
DRAWING NUMBER: OA23398P-DENHAM

543 South Main Street - Sweetwater, TN 37874