

17'10³/₄" X 34'10" LAGOON LEFT

ACCEPTED BY	
DATE	
PURCHASE ORDER

NSPI TYPE	II	SQ. FOOTAGE	624
A	15'2"	K	6'
B	36'7 ¹ / ₂ "	L	14'
D	3'4"	M	10'10"
E	4'8"	M2	-
F	8'	T	-
G	7'2"	S	-
H	4'	N	-
I	4'	P	-
J	4'	U	-

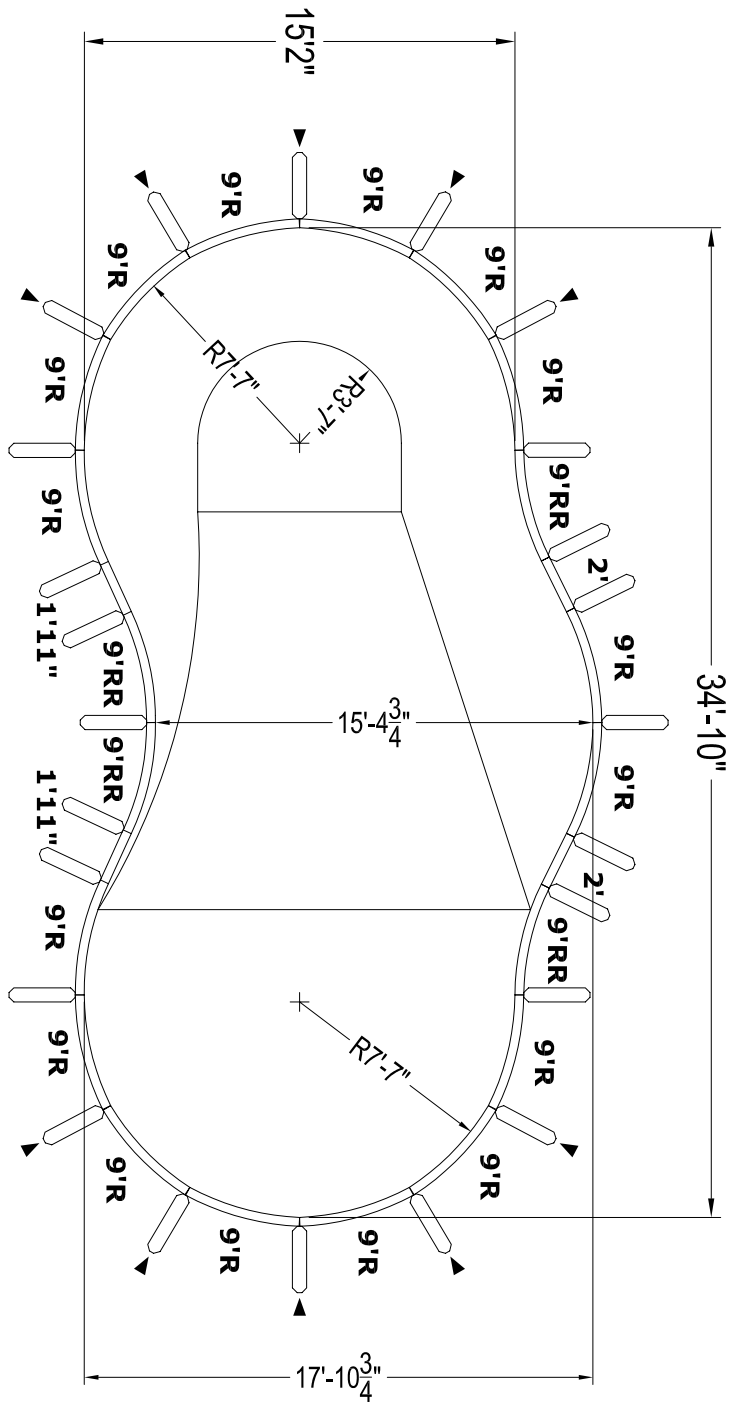
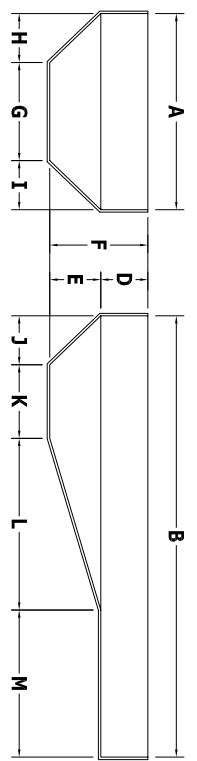

GENERAL NOTES

1. These are finished dimensions ready for the liner.
2. Dimensions are from inside pool panels.
3. The water level should be no more than 6" below the coping receptor (hangab) slot.

EXCAVATION NOTES

1. Rough excavation should be 2" to 3" deeper in each instance.
2. Soil to have minimum bearing capacity of 2000 P.S.F.
3. Locate top of pool at least 6" above surrounding land elevation.
4. See Panel Shell Detail for excavation around pool.
5. Fill voids under base of panels and lamp well.
6. Backfill with non-expansive material.

ADDITIONAL NOTES

THIS DOCUMENT IS FOR ILLUSTRATIVE PURPOSES ONLY. The dealer or contractor who sells or installs your pool is an independent contractor and is not an agent of the Manufacturer. The construction methods illustrated here are suggestions and apply only to normal ground conditions. There may be additional precautions and/or methods of construction. Proper installation is the responsibility of the dealer/contractor.

DATE	APR 2006
------	----------

BILL OF MATERIALS

QTY	PART	DESCRIPTION
2	HP502	2' PANEL
16	HP359	9'R PANEL
4	HP119M	9'R REVERSE
10	HP126	5' WEDGE
24	HP399	BRACE

PANEL SHELF DETAIL

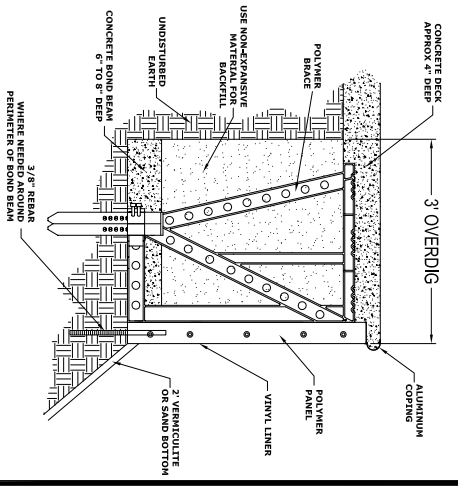

NO DIVING WARNING
NO DIVING WARNING STICKERS MUST BE INSTALLED IN NO DIVING AREAS ACCORDING TO NSPI SPECIFICATIONS

ADANGER
NO DIVING
SHALLOW WATER
DIVING MAY CAUSE DEATH OR PERMANENT INJURY

PRE-CUT PANEL LEGEND



543 South Main Street - Sweetwater, TN 37874

PANEL LINE
PINNACLE
DRAWING NUMBER
LGL15359R8P