

# 18'5" X 34' LAGOON LEFT

ACCEPTED BY	
DATE	
PURCHASE ORDER	

APSP TYPE	0	SQ. FOOTAGE	720
A	185 1/2"	K	2'
B	34'0 1/4"	L	82 1/4"
D	3 1/4"	M	7'10"
E	28"	M2	7'10"
F	6"	T	-
G	14 5/2"	S	-
H	2'	N	-
I	2'	P	-
J	82 1/4"	U	-

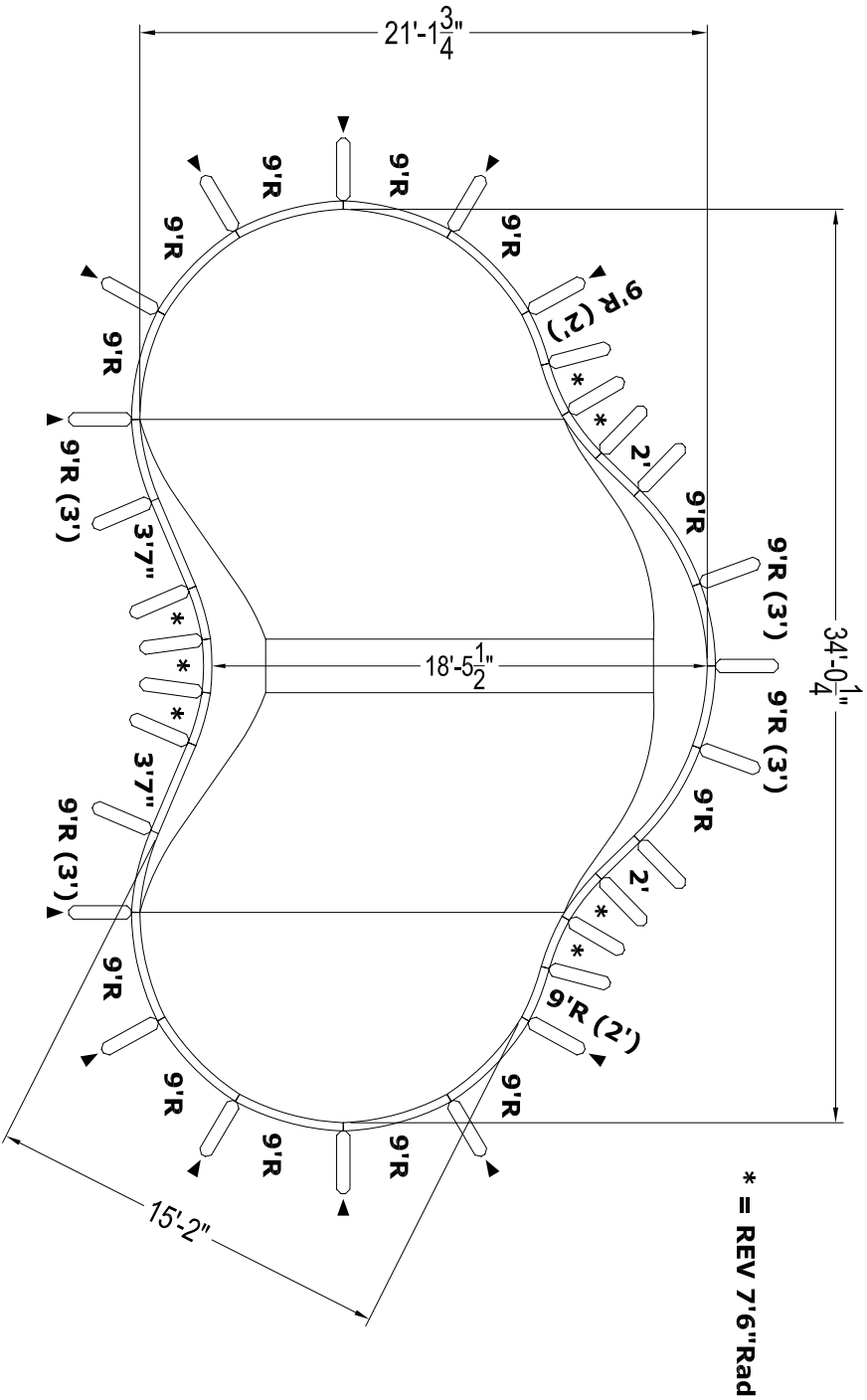
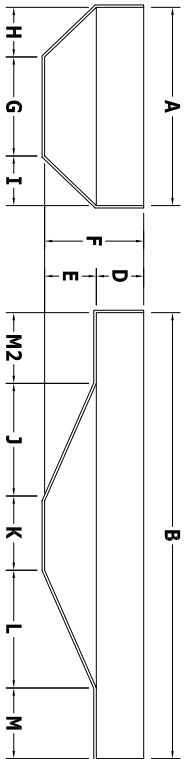

## GENERAL NOTES

1. These are finished dimensions ready for the liner.
2. Dimensions are from inside pool panels.
3. The ideal water level should be to the middle of the skimmer opening(s).

## EXCAVATION NOTES

1. Rough excavation should be 2" deeper in each instance.
2. Soil to have minimum bearing capacity of 2000 P.S.F.
3. Locate top of pool at least 6" above surrounding land elevation.
4. See Panel Shell Detail for excavation around pool.
5. Fill voids under base of panels and lamp well.
6. Backfill with non-expansive material.

## ADDITIONAL NOTES

THIS DOCUMENT IS FOR ILLUSTRATIVE PURPOSES ONLY. The dealer or contractor who sells or installs your pool is an independent contractor and is not an agent of the Manufacturer. The construction methods illustrated here are suggestions and apply only to normal ground conditions. There may be additional precautions and/or methods of construction. Proper installation is the responsibility of the dealer/contractor.

## BILL OF MATERIALS

QTY	PART	DESCRIPTION
2	HP502	2' PANEL
12	HP359	9'R PANEL
4	HP125D	(9'R) 3' ROMAN INSERT
2	HP110D	(9'R) 2' OVAL INSERT
7	HP376N	76"R REVERSE (* )
12	HP126	5" WEDGE
29	HP599	BRACE
2	HP584	37" CUSTOM PANEL

## PANEL SHELF DETAIL

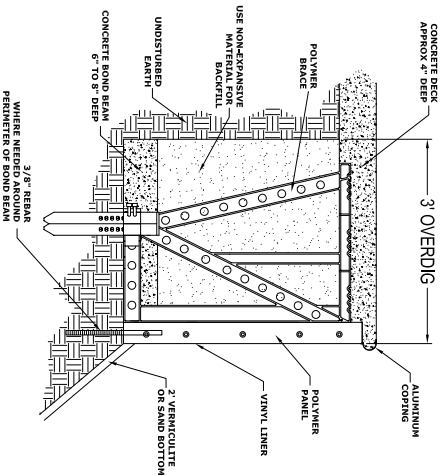

## NO DIVING WARNING

NO DIVING WARNING STICKERS MUST BE INSTALLED IN NO DIVING AREAS ACCORDING TO NSPI SPECIFICATIONS.



## PRE-CUT PANEL LEGEND



543 South Main Street - Sweetwater, TN 37874

DATE  
APR 2007

PANEL LINE  
PINNACLE  
DRAWING NUMBER  
LG118349R6P