

10' X 40' RECTANGLE 6" RADIUS (LAP POOL)

ACCEPTED BY	A	10'	K	38'
	B	40'	L	1'
	D	3 1/4"	M	-
	E	1 1/8"	M2	-
	F	5'	T	-
	G	8'	S	-
	H	1'	N	-
	I	1'	P	-
	J	1'	U	-

APSP TYPE	0	SQ. FOOTAGE	400
-----------	---	-------------	-----

QTY	PART	DESCRIPTION
7	HP506	6' PANEL
1	HP506L	6' PANEL (LIGHT)
2	HP506A	6' PANEL (A/G)
6	HP504	4' PANEL
5	HP156D	6"R PANEL
1	HP522	REVERSE 90° PANEL
22	HP599	BRACE
1	HS108N	STRAIGHT 8' STEP

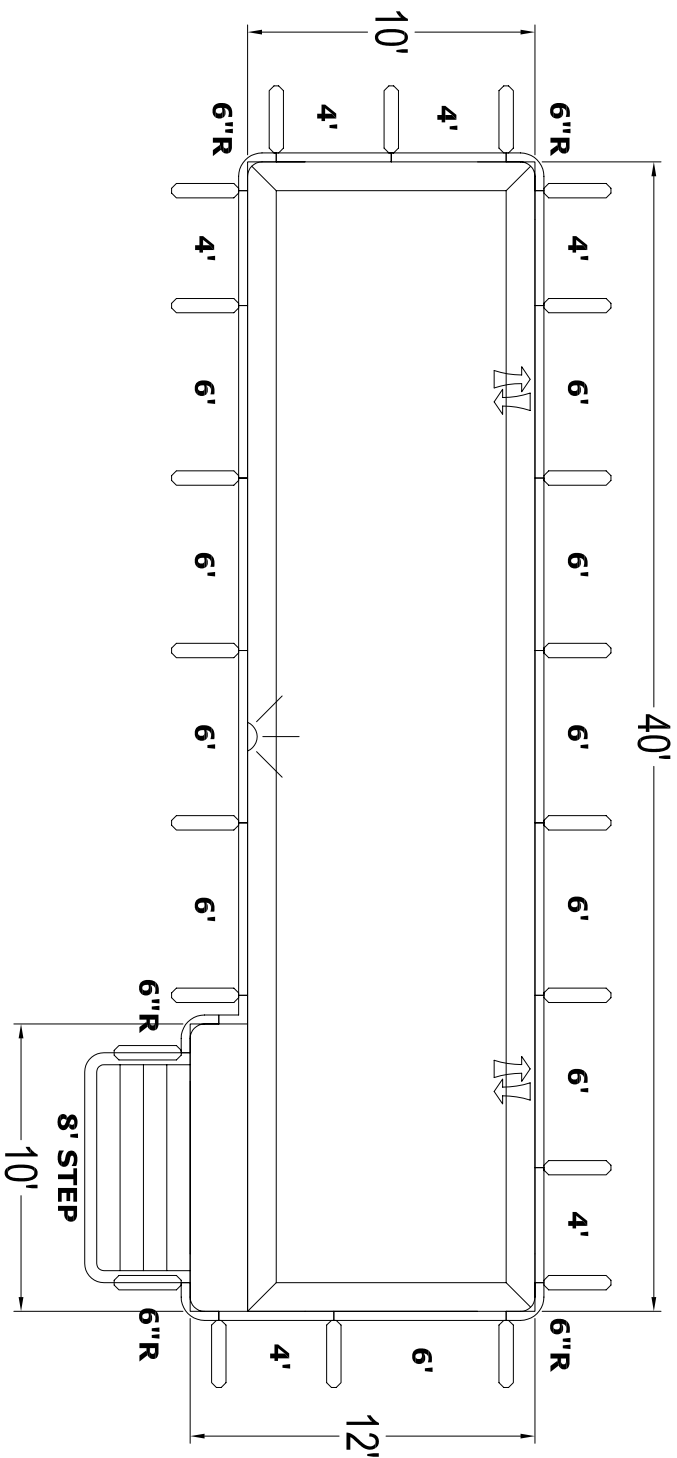
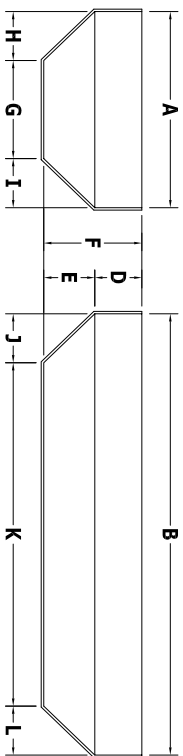

PANEL SHELF DETAIL

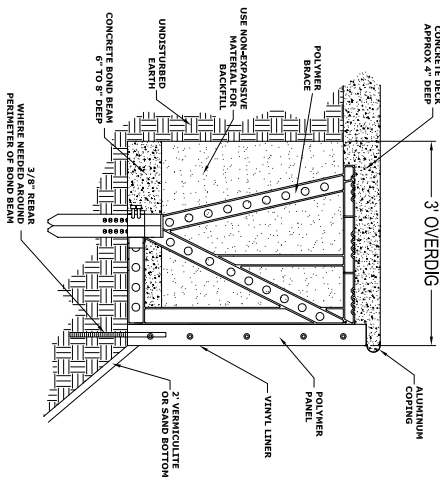

NO DIVING WARNING

NO DIVING WARNING STICKERS MUST BE INSTALLED IN NO DIVING AREAS ACCORDING TO NSPI SPECIFICATIONS.



PRE-CUT PANEL LEGEND



GENERAL NOTES

- These are finished dimensions ready for the liner.
- Dimensions are from inside pool panels.
- The ideal water level should be to the middle of the skimmer opening(s).

EXCAVATION NOTES

- Rough excavation should be 2" deeper in each instance.
- Soil to have minimum bearing capacity of 2000 P.S.F.
- Locate top of pool at least 6" above surrounding land elevation.
- See Panel Shelf Detail for excavation around pool.
- Fill voids under base of panels and lamp well.
- Backfill with non-expansive material.

ADDITIONAL NOTES

THIS DOCUMENT IS FOR ILLUSTRATIVE PURPOSES ONLY. The dealer or contractor who sells or installs your pool is an independent contractor and is not an agent of the Manufacturer. The construction methods illustrated here are suggestions and apply only to normal ground conditions. There may be additional precautions and/or methods of construction. Proper installation is the responsibility of the dealer/contractor.

DATE	FEB 2007
PANEL LINE	PINNACLE
DRAWING NUMBER	RT10406R5P-LAP_8STEP

543 South Main Street - Sweetwater, TN 37874