

10' X 40' RECTANGLE 6" RADIUS (LAP POOL)

ACCEPTED BY	A	10'	K	36'
	B	40'	L	1'
	D	3 1/4"	M	1'
	E	1 1/8"	M2	1'
	F	5'	T	-
	G	8'	S	-
	H	1'	N	-
	I	1'	P	-
	J	1'	U	-

APSP TYPE	0	SQ. FOOTAGE	400
-----------	---	-------------	-----

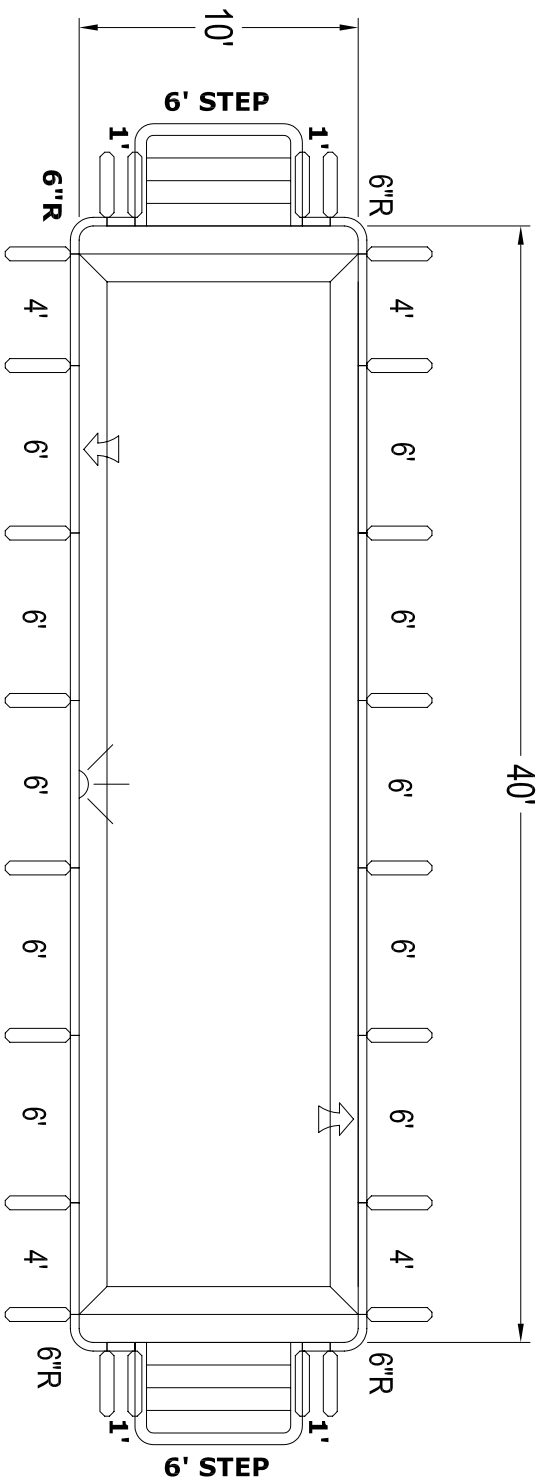

BILL OF MATERIALS

QTY	PART	DESCRIPTION
7	HP506	6' PANEL
1	HP506L	6' PANEL (LIGHT)
2	HP5064	6' PANEL (1084)
4	HP504	4' PANEL
4	HP501	1' PANEL
4	HP-156D	6"R PANEL
24	HP599	BRACE
2	HS105N	STRAIGHT 6' STEP

PANEL SHELF DETAIL

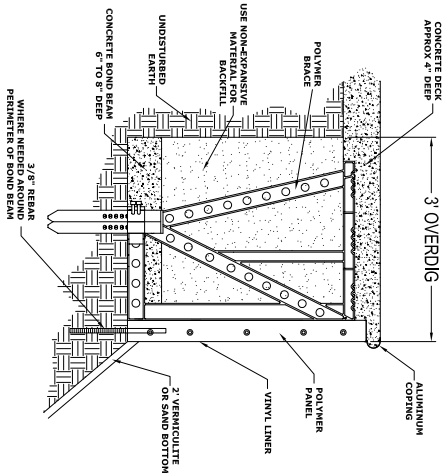

NO DIVING WARNING

NO DIVING WARNING STICKERS MUST BE INSTALLED IN NO DIVING AREAS ACCORDING TO NSPI SPECIFICATIONS.



PRE-CUT PANEL LEGEND



GENERAL NOTES

- These are finished dimensions ready for the liner.
- Dimensions are from inside pool panels.
- The water level should be no more than 6" below the coping receptor (hangtab) slot.

EXCAVATION NOTES

- Rough excavation should be 2" to 3" deeper in each instance.
- Soil to have minimum bearing capacity of 2000 P.S.F.
- Locate top of pool at least 6" above surrounding land elevation.
- See Panel Shell Detail for excavation around pool.
- Fill voids under base of panels and lamp well.
- Backfill with non-expansive material.

ADDITIONAL NOTES

THIS DOCUMENT IS FOR ILLUSTRATIVE PURPOSES ONLY. The dealer or contractor who sells or installs your pool is an independent contractor and is not an agent of the Manufacturer. The construction methods illustrated here are suggestions and apply only to normal ground conditions. There may be additional precautions and/or methods of construction. Proper installation is the responsibility of the dealer/distributor/contractor.



543 South Main Street - Sweetwater, TN 37874

DATE
JAN 2007

PANEL LINE
PINNACLE

DRAWING NUMBER
RT10406R5P-LAP