

23'3" X 37'4" OASIS

ACCEPTED BY	A	186 ³ / ₄ "	K	66 ¹ / ₂ "
	B	37 ³ / ₄ "	L	7'
	D	3'4"	M	85 ⁵ / ₄ "
	E	1'8"	M2	86"
	F	5'	T	22'1"
DATE	G	VARIES	S	23'3"
	H	2'	N	-
	I	2'	P	-
PURCHASE ORDER	J	7'	U	-
AQUATIC				

NSPI TYPE	0	AREA	867
-----------	---	------	-----

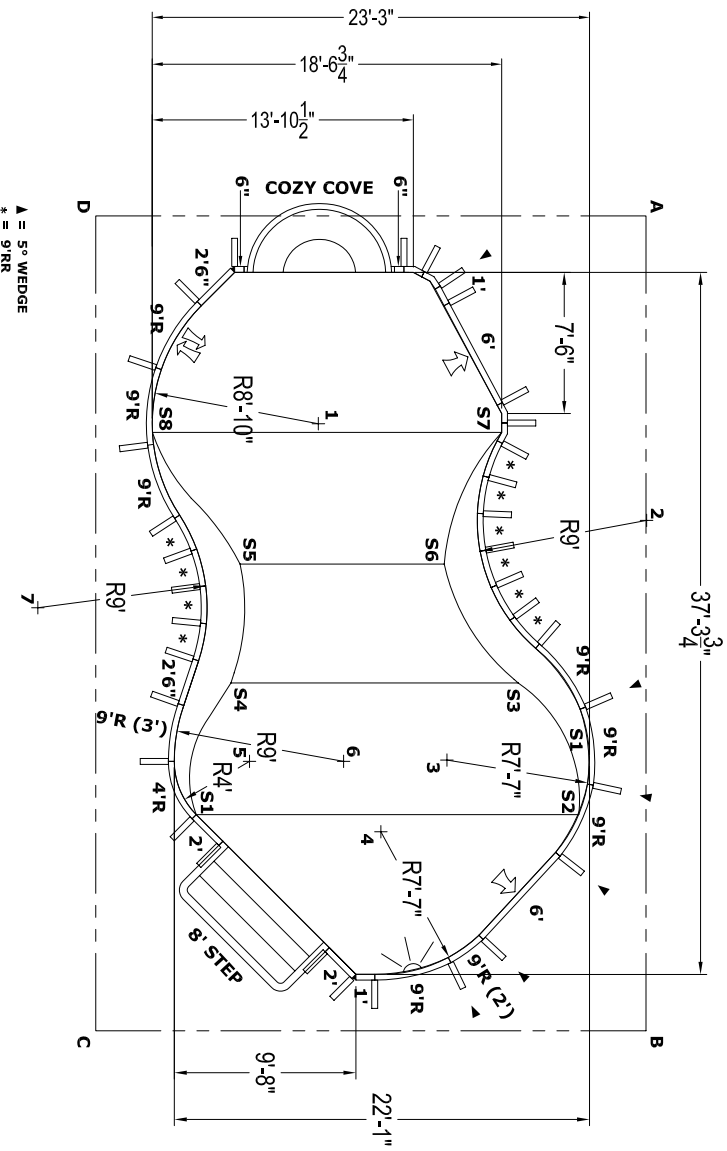

LAYOUT DIMENSIONS

A-B	43'3 ³ / ₄ "
A-C	52'3"
B-C	29'3"

SLOPE & HOPPER LAYOUT

S1-B	26'6 ¹ / ₄ "	S6-A	21'1 ¹ / ₂ "
S1-C	12'8"	S6-B	27'1 ¹ / ₄ "
S2-B	12'1 ¹ / ₄ "	S7-A	13'10"
S2-C	28'1'1 ¹ / ₂ "	S7-D	24'5'1 ¹ / ₄ "
S3-A	25'8'3 ³ / ₄ "	S8-A	28'7'3 ³ / ₄ "
S3-B	19'8'1 ¹ / ₄ "	S8-D	11'10'3 ³ / ₄ "
S4-C	19'10"		
S4-D	25'10"		
S5-C	25'11'1 ¹ / ₂ "		
S5-D	20'1 ¹ / ₂ "		

GENERAL NOTES

- These are finished dimensions ready for the liner.
- Dimensions are from inside pool panels.
- The water level should be no more than 6" below the coping receptor (hangtab) slot.

EXCAVATION NOTES

- Rough excavation should be 2" to 3" deeper in each instance.
- Soil to have minimum bearing capacity of 2000 P.S.F.
- Locate top of pool at least 6" above surrounding land elevation.
- See Panel Shell Detail for excavation around pool.
- Fill voids under base of panels and lamp well.
- Backfill with non-expansive material.

ADDITIONAL NOTES

THIS DOCUMENT IS FOR ILLUSTRATIVE PURPOSES ONLY. The dealer or contractor who sells or installs your pool is an independent contractor and is not an agent of the Manufacturer. The construction methods illustrated here are suggestions and apply only to normal ground conditions. There may be additional precautions and/or methods of construction. Proper installation is the responsibility of the dealer/contractor.

DATE	JUN 2007
PANEL LINE	HYDRA

BILL OF MATERIALS

QTY	PART	DESCRIPTION
2	HP1064	6" PANEL (1084)
2	HP183S	26" SPECIAL PANEL
2	HP102	2' PANEL
2	HP101	1' PANEL
2	HP111	6" FILLER PANEL
9	HP159	9R PANEL
1	HP159LL	9R PANEL (LIGHT)
1	HP159A	9R PANEL (A/G)
1	HP125	(9R) 3' ROMAN INSERT
1	HP110	(9R) 2' OVAL INSERT
10	HP119N	9R REVERSE
1	HP154	4R PANEL
4	HP121	30° LAZY-ELL PANEL
2	HP113	45° WEDGE
6	HP126	5° WEDGE
34	HP199	BRACE
1	HS107N	STRAIGHT 8' STEP

PANEL SHELL DETAIL

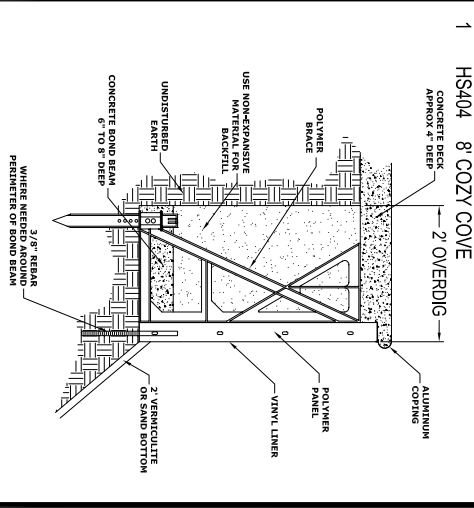

NO DIVING WARNING

NO DIVING WARNING STICKERS MUST BE INSTALLED IN NO DIVING AREAS ACCORDING TO NSPI SPECIFICATIONS



PRE-CUT PANEL LEGEND



543 South Main Street - Sweetwater, TN 37874

DRAWING NUMBER: OA23379RSH-AQUATIC

Copyright © 2007 by Hydra Pools.