

23'0³/₄" X 37'3¹/₂" OASIS

ACCEPTED BY

A	21'7 ¹ / ₂ "	K	10'10"
B	37'3 ¹ / ₂ "	L	14'
D	3'4"	M	8'11 ¹ / ₂ "
E	4'8"	M2	-
F	8'	T	-
G	14'7 ¹ / ₂ "	S	-
H	3'6"	N	-
I	3'6"	P	-
J	3'6"	U	-

NSPI TYPE

II

SQ. FOOTAGE

862

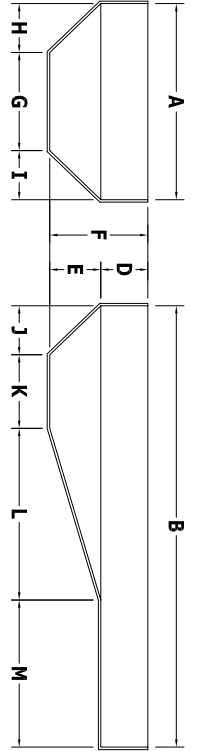

PURCHASE ORDER

DATE

DATE

BILL OF MATERIALS

QTY	PART	DESCRIPTION
2	HP506	6' PANEL
2	HP505	5' PANEL
1	HP504	4' PANEL
1	HP503	3' PANEL
1	HP502	2' PANEL
2	HP501	1' PANEL
7	HP359	9R PANEL
1	HP359LL	9R PANEL (LIGHT)
1	HP110D	(9R) 2 OVAL INSERT
5	HP119M	9R REVERSE
1	HP354	4R PANEL
4	HP521	30° LAZY-ELL PANEL
2	H01576	45° WEDGE
3	HP126	5° WEDGE
29	HP599	BRACE
1	HS104N	STRAIGHT 6' STEP

PANEL SHELF DETAIL

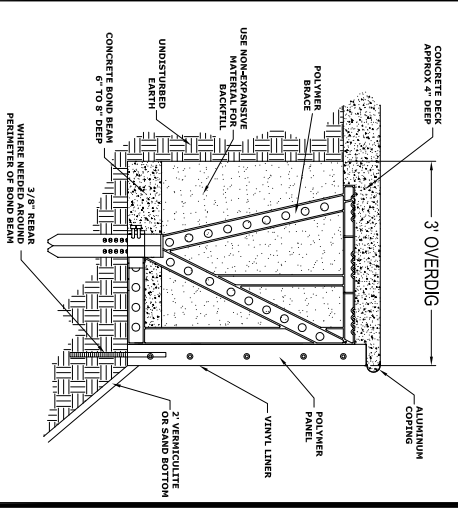

NO DIVING WARNING

NO DIVING WARNING STICKERS MUST BE INSTALLED IN NO DIVING AREAS ACCORDING TO NSPI SPECIFICATIONS



PRE-CUT PANEL LEGEND

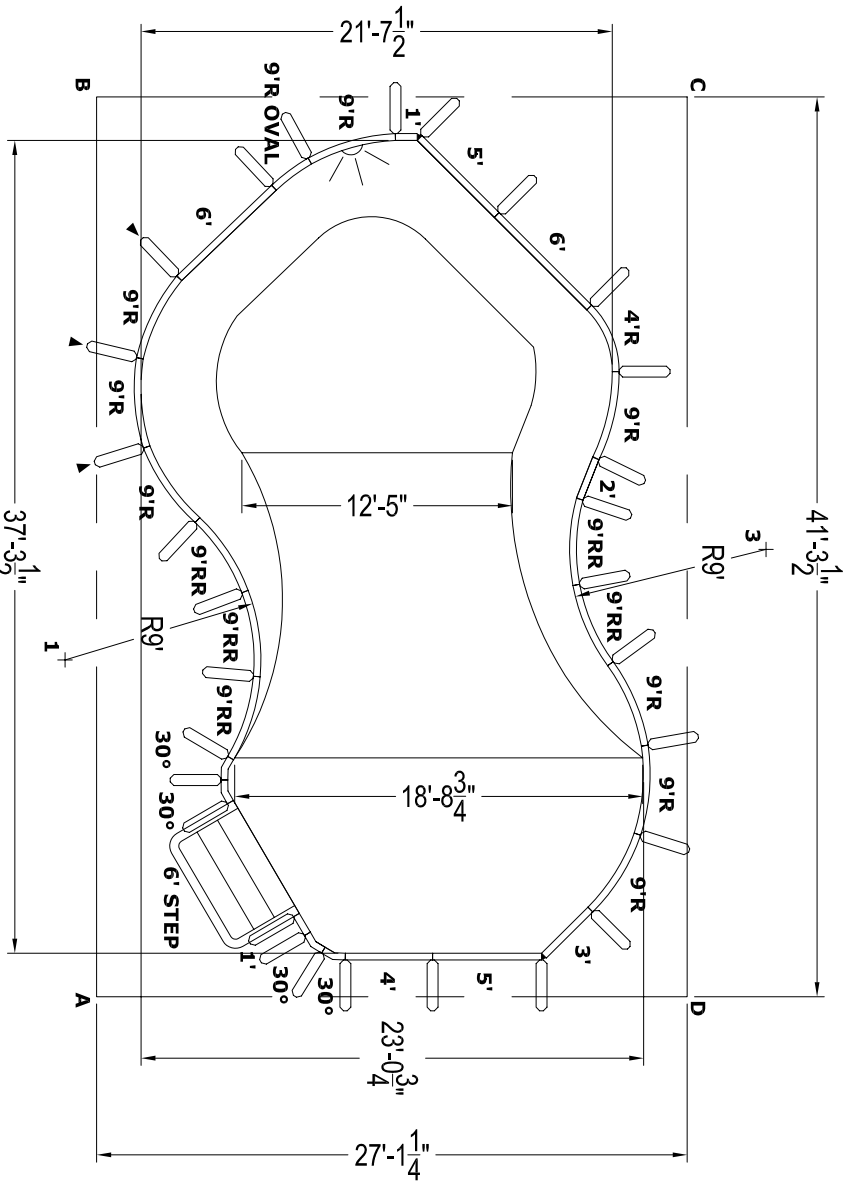

GENERAL NOTES

- These are finished dimensions ready for the liner.
- Dimensions are from inside pool panels.
- The water level should be no more than 6" below the coping receptor (hangab) slot.

EXCAVATION NOTES

- Rough excavation should be 2" to 3" deeper in each instance.
- Soil to have minimum bearing capacity of 2000 P.S.F.
- Locate top of pool at least 6" above surrounding land elevation.
- See Panel Shelf Detail for excavation around pool.
- Fill voids under base of panels and lamp well.
- Backfill with non-expansive material.

ADDITIONAL NOTES

THIS DOCUMENT IS FOR ILLUSTRATIVE PURPOSES ONLY. The dealer or contractor who sells or installs your pool is an independent contractor and is not an agent of the Manufacturer. The construction methods illustrated here are suggestions and apply only to normal ground conditions. There may be additional precautions and/or methods of construction. Proper installation is the responsibility of the dealer/contractor.

DATE: APR 2006

PANEL LINE: PINNACLE

DRAWING NUMBER: OA2337-NPW

543 South Main Street - Sweetwater, TN 37874

HYDRA POOLS

Copyright © 2005 by Hydra Pools.