

# 23'3" X 37'4" OASIS

ACCEPTED BY	A	22'-1"	K	7'-6"
	B	37'-3 <sup>3/4</sup> "	L	14'
	D	3'-4"	M	11'-9 <sup>3/4</sup> "
	E	4'-8"	M2	-
	F	8'	T	-
	G	14'-1"	S	-
	H	4'	N	-
	I	4'	P	-
	J	4'	U	-

NSPI TYPE	II	SQ. FOOTAGE	868
-----------	----	-------------	-----

QTY	PART	DESCRIPTION
1	HP506	6' PANEL
1	HP506L	6' PANEL (LIGHT)
2	HP506A	6' PANEL (A/G)
2	HP583S	26" SPECIAL PANEL
3	HP501	1' PANEL
7	HP359	9R PANEL
1	HP125D	(9R) 3' ROMAN INSERT
1	HP110D	(9R) 2' OVAL INSERT
5	HP119M	9R REVERSE
1	HP364	4R PANEL
4	HP521	30° LAZY-ELL PANEL
2	H01576	45° WEDGE
6	HP126	5° WEDGE
29	HP359	BRACE
1	HS107N	STRAIGHT 8' STEP

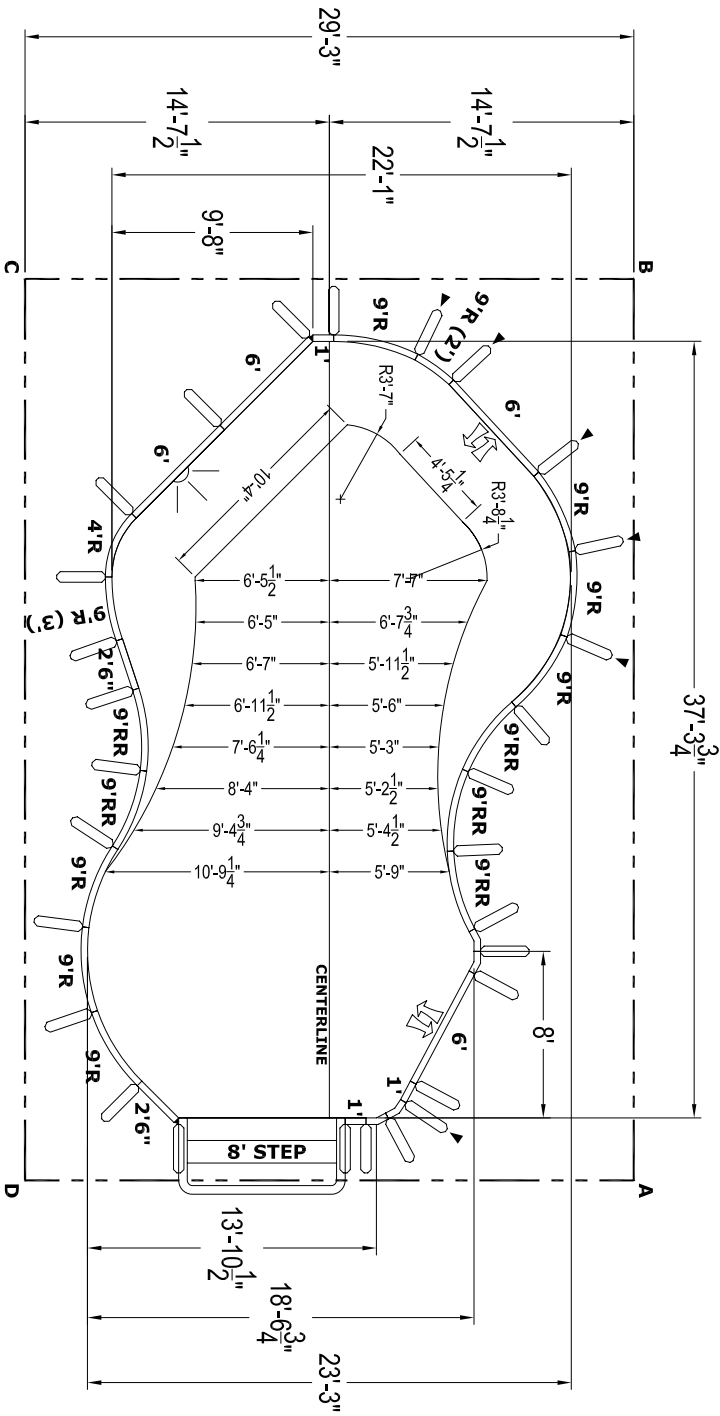
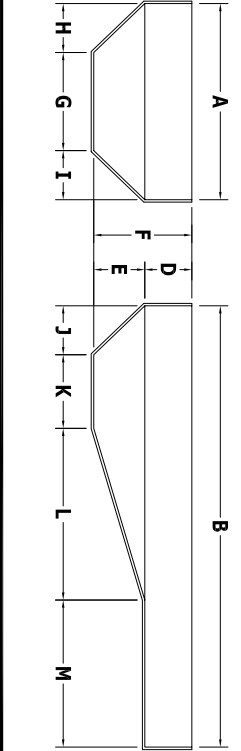

### PANEL SHELF DETAIL

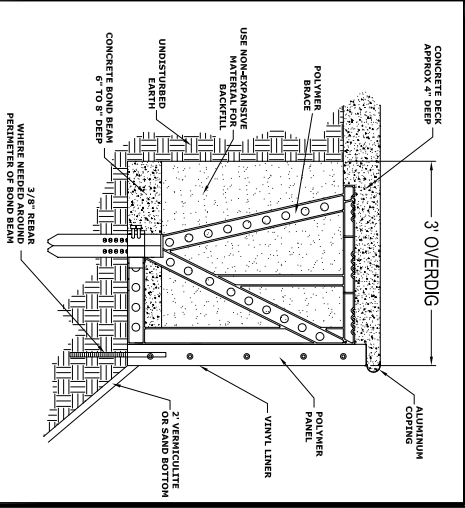

### NO DIVING WARNING

NO DIVING WARNING STICKERS MUST BE INSTALLED IN NO DIVING AREAS ACCORDING TO NSPI SPECIFICATIONS.



### PRE-CUT PANEL LEGEND



### GENERAL NOTES

1. These are finished dimensions ready for the liner.
2. Dimensions are from inside pool panels.
3. The water level should be no more than 6" below the coping receptor (hangtab) slot.

### EXCAVATION NOTES

1. Rough excavation should be 2" to 3" deeper in each instance.
2. Soil to have minimum bearing capacity of 2000 P.S.F.
3. Locate top of pool at least 6" above surrounding land elevation.
4. See Panel Shelf Detail for excavation around pool.
5. Fill voids under base of panels and lamp well.
6. Backfill with non-expansive material.

### ADDITIONAL NOTES

THIS DOCUMENT IS FOR ILLUSTRATIVE PURPOSES ONLY. The dealer or contractor who sells or installs your pool is an independent contractor and is not an agent of the Manufacturer. The construction methods illustrated here are suggestions and apply only to normal ground conditions. There may be additional precautions and/or methods of construction. Proper installation is the responsibility of the dealer/distributor/contractor.

DATE	APR 2006
PANEL LINE	PINNACLE
DRAWING NUMBER	OA23379R8P

543 South Main Street - Sweetwater, TN 37874