

| REVISION HISTORY |                         |           |     |       |
|------------------|-------------------------|-----------|-----|-------|
| REV.             | DESCRIPTION             | DATE      | ECO | BY    |
| A                | RELEASED FOR PRODUCTION | 1/25/2021 |     | adold |

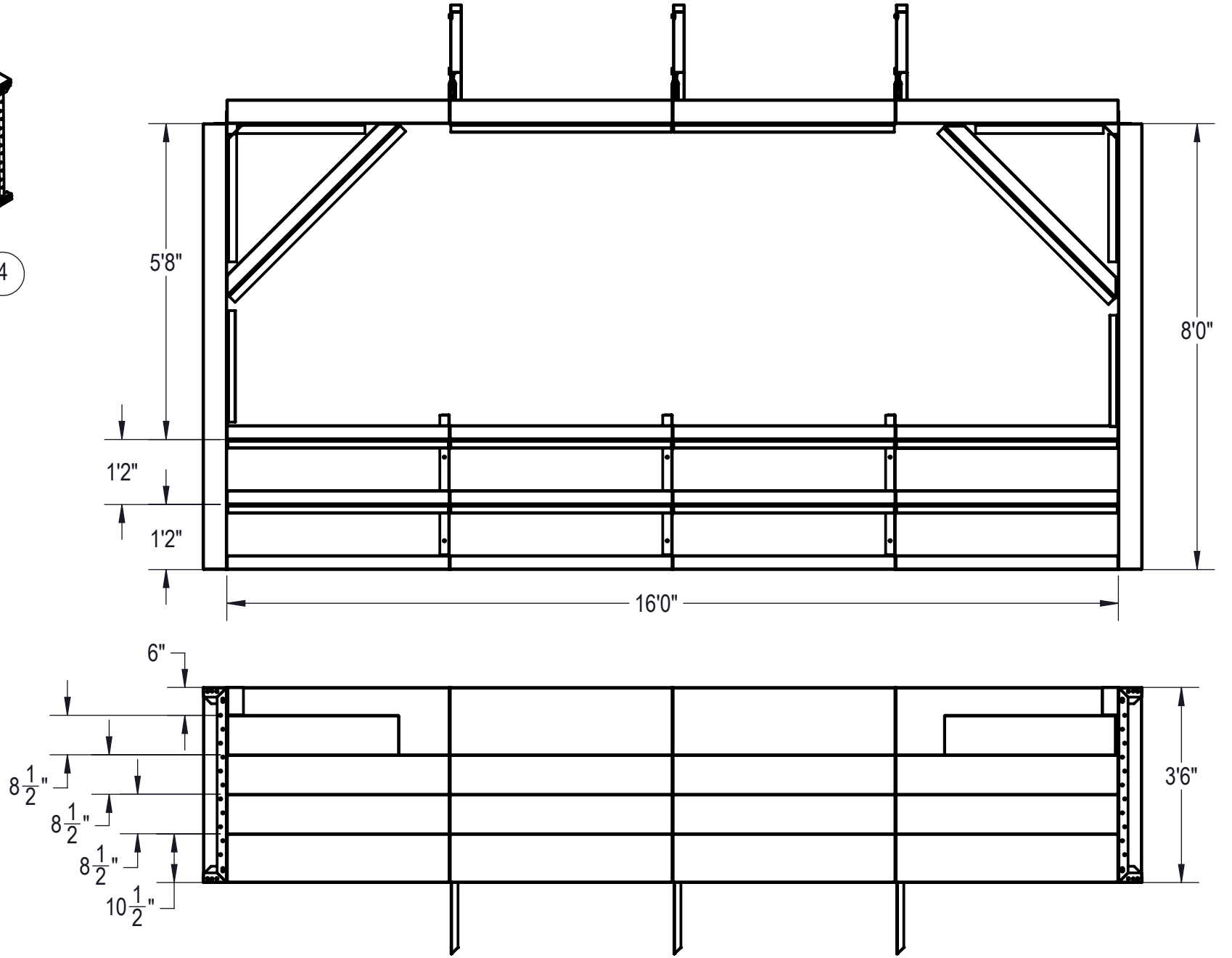
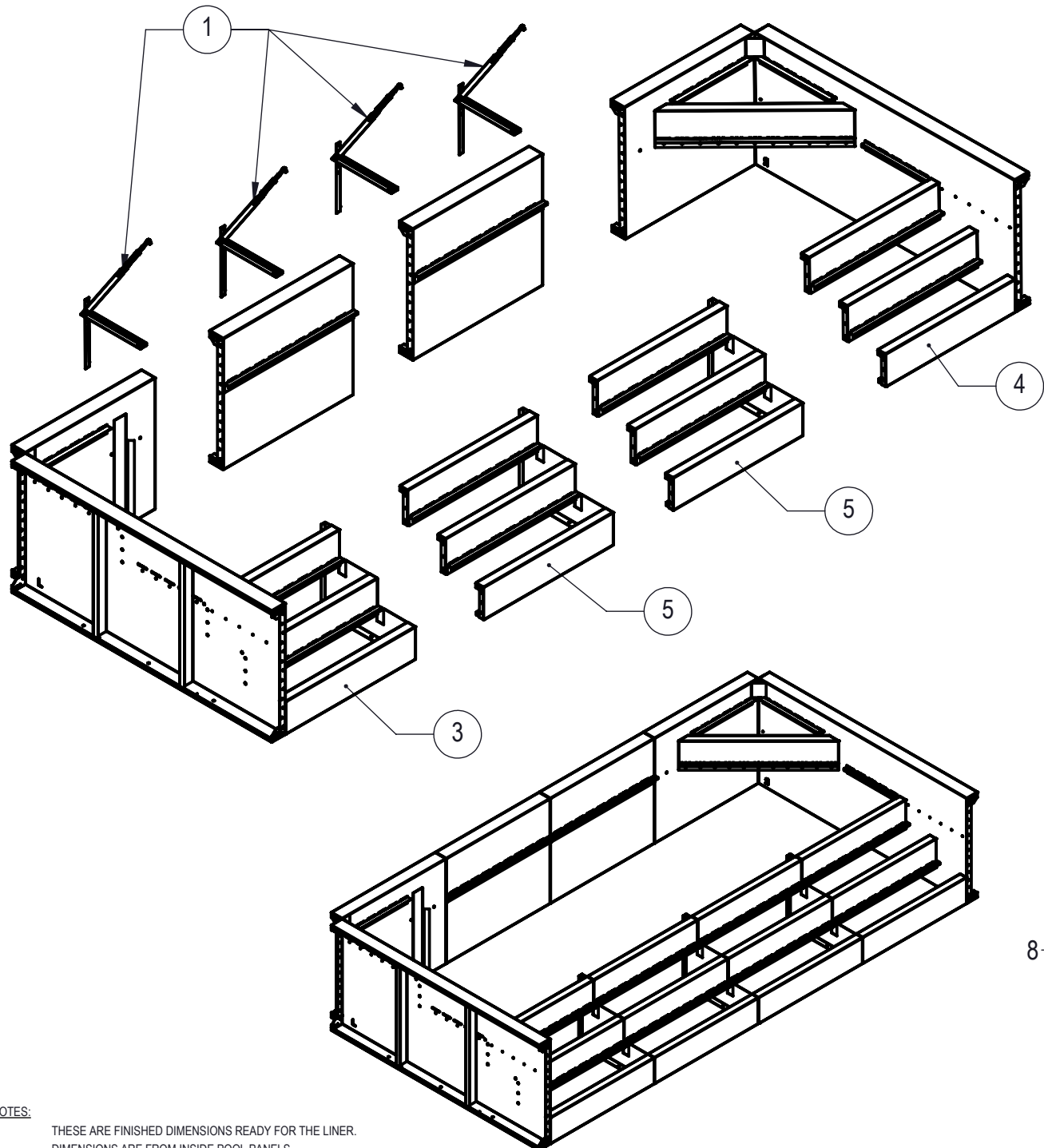

**NOTES:**

1. THESE ARE FINISHED DIMENSIONS READY FOR THE LINER.
2. DIMENSIONS ARE FROM INSIDE POOL PANELS.
3. ROPE AND FLOAT ASSEMBLY SHOULD BE INSTALLED IN ACCORDANCE WITH CURRENT ANSI/ASPS/ICC REGULATIONS
4. HYDRA LINER TRACK FOR STEPS IS INSTALLED WITH THE BARB FACING THE RISER WALL ON THE STEP.

**EXCAVATION NOTES:**

5. ROUGH EXCAVATION SHOULD BE 2" DEEPER IN EACH INSTANCE.
6. SOIL TO HAVE MINIMUM BEARING CAPACITY OF 1500 PSF.
7. LOCATE TOP OF POOL AT LEAST 6" ABOVE THE SURROUNDING LAND ELEVATION.
8. SEE "OVER DIG DETAIL" FOR EXCAVATION AROUND POOL.
9. FILL VOIDS UNDER BASE OF PANELS AND TAMP WELL.
10. BACK FILL WITH NON-EXPANSIVE MATERIAL.
11. FOLLOW ALL CURRENT ANSI / A P S P / ICC GUIDELINES FOR RESIDENTIAL POOLS

**IMPORTANT NOTES:**

THIS DOCUMENT IS FOR ILLUSTRATIVE PURPOSES ONLY. THE DEALER OR CONTRACTOR WHO SELLS OR INSTALLS YOUR POOL IS AN INDEPENDENT CONTRACTOR AND IS NOT AN AGENT OF THE MANUFACTURER. THE CONSTRUCTION METHODS ILLUSTRATED HERE ARE SUGGESTIONS AND APPLY ONLY TO NORMAL GROUND CONDITIONS. THERE MAY BE ADDITIONAL PRECAUTIONS AND/OR METHODS OF CONSTRUCTION. PROPER INSTALLATION IS THE RESPONSIBILITY OF THE DEALER/BUILDER/CONTRACTOR.

| ITEM | FILE NAME  | DESCRIPTION  | CUSTOMER DRAWING # | VENDOR PART # | QTY. |
|------|------------|--|--------------------|---------------|------|
| 1    | HPSFOB     |  | HPSFOB             |               | 4    |
| 2    | BOLT, PACK | BOLT, FLANGE, 3/8-16 X 1", PACK (50)   | HPS1916            | HPS1916       | 4    |
| 3    | 00034416   | STEP, CORNER TOP TREAD, 4" X 8", 6" RADIUS, 4 TREAD, LEFT, OPEN POUR, TANNING LEDGE, SUB ASSEMBLY      | HSSM34416          | 00034416      | 1    |
| 4    | 00034502   | STEP, CORNER TOP TREAD, 4" X 8", 6" RADIUS, 4 TREAD, RIGHT, OPEN POUR, TANNING LEDGE, SUB ASSEMBLY     | HSSM34502          | 00034502      | 1    |
| 5    | 00034420   | STEP, CORNER TOP TREAD, 4" X 8", 6" RADIUS, 4 TREAD, 4 SECTION, OPEN POUR, TANNING LEDGE, SUB ASSEMBLY | HSSM34420          | 00034420      | 2    |

|   |                              |   |                           |                                 |  |
|---|------------------------------|---|---------------------------|---------------------------------|--|
| ENGINEERING DRAWING NUMBER<br><b>00034864</b> | WEIGHT:<br>lbs               | <b>UNLESS OTHERWISE SPECIFIED</b><br>DIMENSIONS ARE IN INCHES<br>TOLERANCES<br>DECIMALS: X ±<br>XX ±<br>XXX ±<br>XXXX ±<br>ANGULAR: X ± 0.5<br>THIRD ANGLE PROJECTION<br> | DESIGNED BY:<br>ADOLD     | CREATION DATE:<br>1/8/2021      | <b>SAMSON STEEL</b><br><br>TITLE: STEP, CORNER TOP TREAD, 8" X 16", 6" RADIUS, 4 TREAD, OPEN POUR, 5'8" TANNING LEDGE, ASSEMBLY<br><br>PART NUMBER:<br><span style="font-size: 24pt;"><b>00034864</b></span> |
|   | VOLUME:<br>Inch <sup>3</sup> |   | DETAILED BY:<br>adold     | DETAILED DATE:<br>1/25/2021     |  |
|   | COLOR:                       |   | LAST REVISED BY:<br>adold | LAST REVISED DATE:<br>1/25/2021 |  |
|   | HEAT TREAT:                  |   | MATERIAL:                 |                                 |  |
| FINISH:                                       |                              |   |                           |                                 | SCALE:<br>1:32   |
| TEXTURE:                                      |                              |   |                           |                                 | SIZE:<br>B   |

| REVISION HISTORY |                         |            |     |      |
|------------------|-------------------------|------------|-----|------|
| REV.             | DESCRIPTION             | DATE       | ECO | BY   |
| A                | RELEASED FOR PRODUCTION | 12/22/2020 |     | adol |

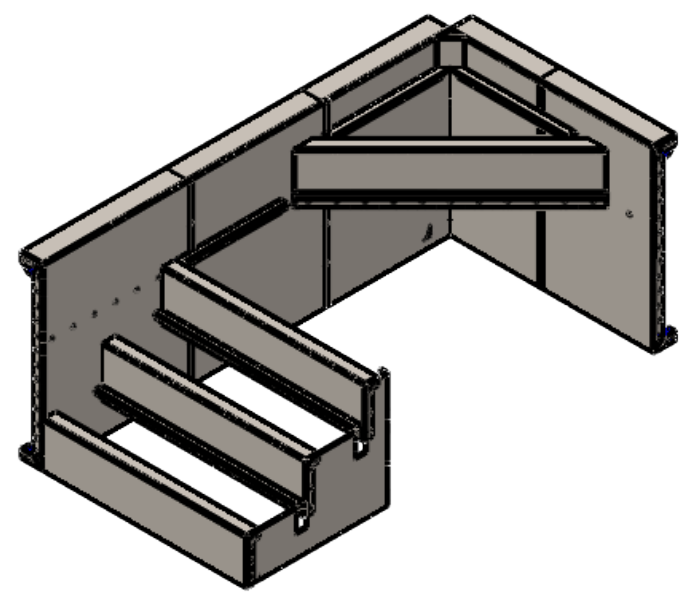
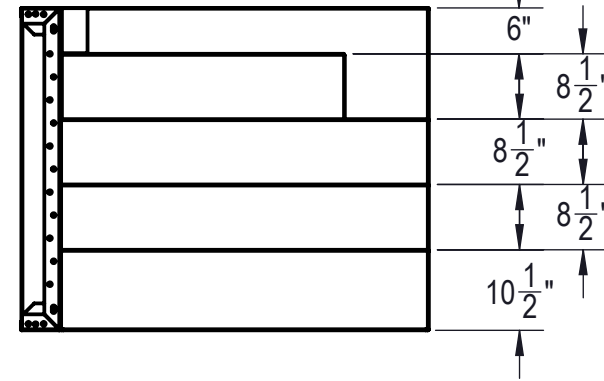
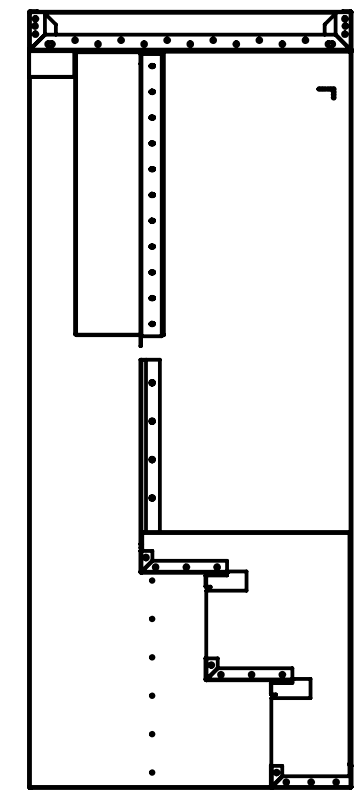
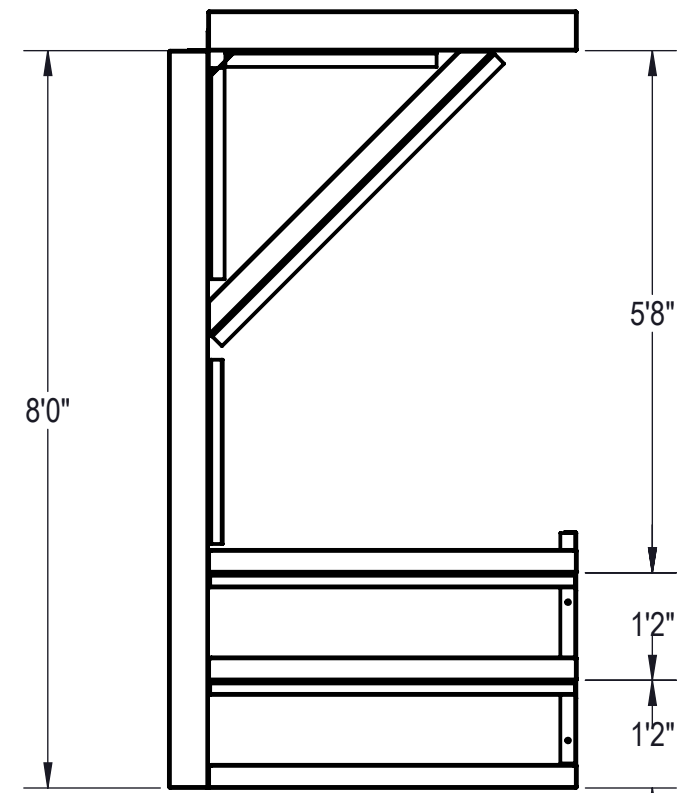
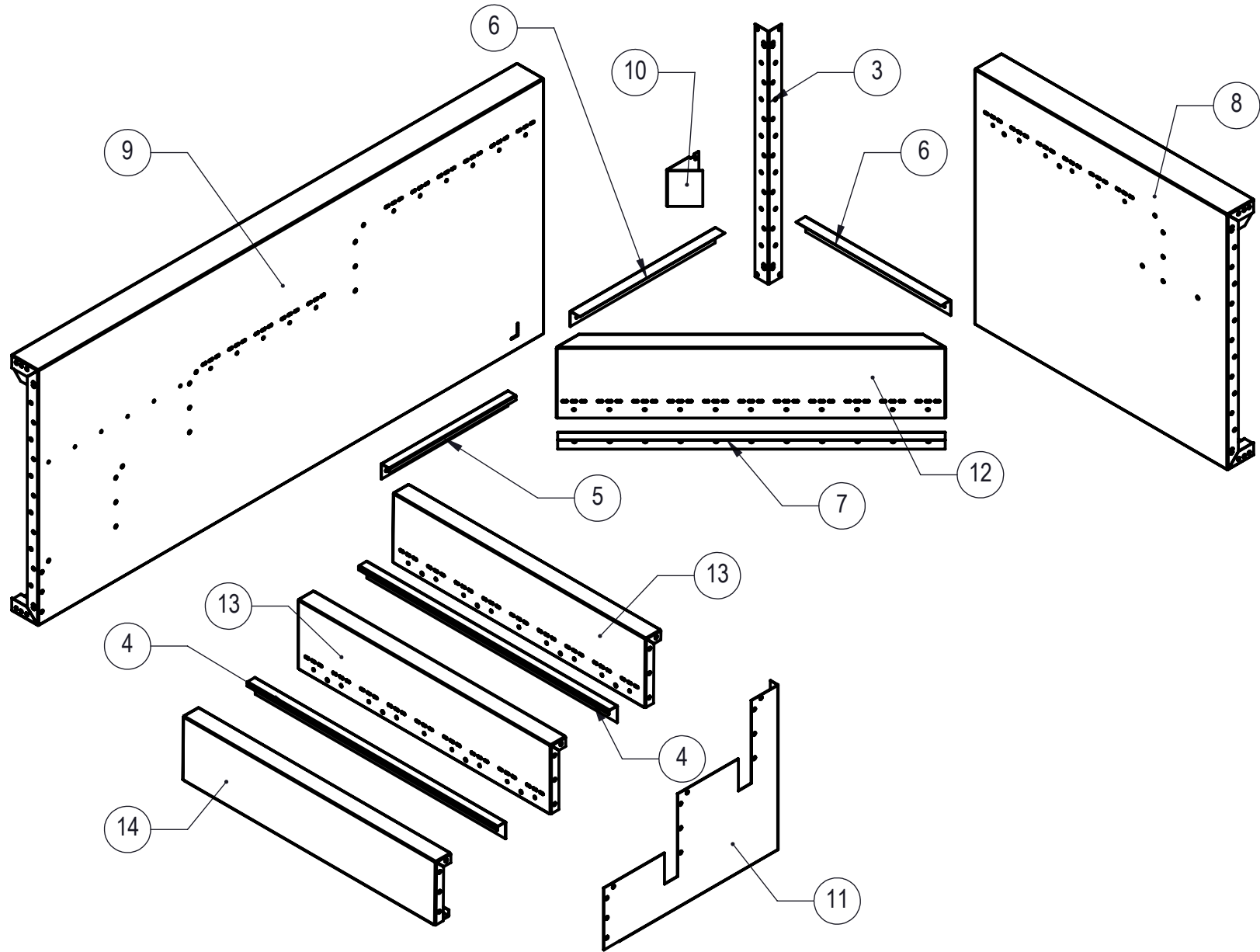

**NOTES:**

- THESE ARE FINISHED DIMENSIONS READY FOR THE LINER.
  - DIMENSIONS ARE FROM INSIDE POOL PANELS.
  - ROPE AND FLOAT ASSEMBLY SHOULD BE INSTALLED IN ACCORDANCE WITH CURRENT ANSI/ASPS/ICC REGULATIONS
  - HYDRA LINER TRACK FOR STEPS IS INSTALLED WITH THE BARB FACING THE RISER WALL ON THE STEP.
- EXCAVATION NOTES:**
- ROUGH EXCAVATION SHOULD BE 2" DEEPER IN EACH INSTANCE.
  - SOIL TO HAVE MINIMUM BEARING CAPACITY OF 1500 PSF.
  - LOCATE TOP OF POOL AT LEAST 6" ABOVE THE SURROUNDING LAND ELEVATION.
  - SEE "OVER DIG DETAIL" FOR EXCAVATION AROUND POOL.
  - FILL VOIDS UNDER BASE OF PANELS AND TAMP WELL.
  - BACK FILL WITH NON-EXPANSIVE MATERIAL.
  - FOLLOW ALL CURRENT ANSI / ASPSP / ICC GUIDELINES FOR RESIDENTIAL POOLS
- IMPORTANT NOTES:**

THIS DOCUMENT IS FOR ILLUSTRATIVE PURPOSES ONLY. THE DEALER OR CONTRACTOR WHO SELLS OR INSTALLS YOUR POOL IS AN INDEPENDENT CONTRACTOR AND IS NOT AN AGENT OF THE MANUFACTURER. THE CONSTRUCTION METHODS ILLUSTRATED HERE ARE SUGGESTIONS AND APPLY ONLY TO NORMAL GROUND CONDITIONS. THERE MAY BE ADDITIONAL PRECAUTIONS AND/OR METHODS OF CONSTRUCTION. PROPER INSTALLATION IS THE RESPONSIBILITY OF THE DEALER/BUILDER/CONTRACTOR.

| ITEM | FILE NAME  | DESCRIPTION   | CUSTOMER DRAWING # | VENDOR PART # | QTY. |
|------|------------|---|--------------------|---------------|------|
| 1    | BOLT, PACK | BOLT, FLANGE, 3/8-16 X 1", PACK (50)  | HPS1916            | HPS1916       | 2    |
| 2    | SBRACE     | BRACE, FOLD OVER WITH TURNBUCKLE, STEEL, HPSFOB   | HPSFOB             | HPSFOB        | 1    |
| 3    | 00000051   | CONNECTOR, CORNER, 2 1/2" X 1 1/2" X 90°  | HPSD90C            | HPSD90C       | 1    |
| 4    | 00017122   | LINER TRACK, OPEN POUR  | 00017122           | 00017122      | 2    |
| 5    | 00034424   | LINER TRACK, RIGHT OR LEFT, 28"   | 00034434           | 00034434      | 1    |
| 6    | 00028268   | LINER TRACK, TREAD "A"  | 00028268           | 00028268      | 2    |
| 7    | 00028269   | LINER TRACK, TREAD "B"  | 00028269           | 00028269      | 1    |
| 8    | 00034418   | PANEL BACK, LEFT, 4' LONG, 4 TREAD, OPEN POUR, CORNER FIRST STEP, TANNING LEDGE, ASSEMBLY | 00034418           | 00034418      | 1    |
| 9    | 00034419   | PANEL, STEP, 4 TREAD, BENCH, LEFT SIDE, OPEN POUR, BENCH OPTION, ASSEMBLY                 | 00034419           |               | 1    |
| 10   | 00010294   | STEP, 4 TREAD, 90 DEGREE, CORNER, 6" RADIUS FILLER, FITS 10269                            |                    |               | 1    |
| 11   | 00034413   | SUPPORT, CENTER, 4 TREAD, OPEN POUR   | 00034413           | 00034413      | 1    |
| 12   | 00034425   | TREAD, STEP, 4 TREAD, CORNER, TREAD "A", OPEN POUR  | 00034425           | 00034425      | 1    |
| 13   | 00034411   | TREAD, STEP, 4 TREAD, OPEN POUR, "B", 4"  | 00034411           | 00034411      | 2    |
| 14   | 00034412   | TREAD, STEP, 4 TREAD, OPEN POUR, "C", 4' LONG   | 00034412           | 00034412      | 1    |

|   |   |   |   |   |   |
|---|---|---|---|---|---|
| ENGINEERING DRAWING NUMBER<br><b>00034416</b> | WEIGHT: lbs<br>VOLUME: Inch <sup>3</sup><br>COLOR: NA<br>HEAT TREAT: NA<br>FINISH: NA<br>TEXTURE: 576 | <b>UNLESS OTHERWISE SPECIFIED</b><br>DIMENSIONS ARE IN INCHES<br>TOLERANCES<br>DECIMALS: X ±<br>XX ±<br>XXX ±<br>XXXX ±<br>ANGULAR: X ± 0.5<br>THIRD ANGLE PROJECTION | DESIGNED BY: ADOLD<br>DETAILED DATE: 1/25/2021<br>LAST REVISED BY: adold<br>MATERIAL: | CREATION DATE: 1/9/2018<br>DETAILED DATE: 1/25/2021<br>LAST REVISED DATE: 1/25/2021 | <b>SAMSON STEEL</b><br><br>TITLE: STEP, CORNER TOP TREAD, 4' X 8', 6" RADIUS, 4 TREAD, LEFT, OPEN POUR, TANNING LEDGE, SUB ASSEMBLY |
|   | PART NUMBER: <b>HSSM34416</b>   |   |   | SCALE: 1:32<br>SHEET: 2 OF 4  | SIZE: <b>B</b>  |

| REVISION HISTORY |                         |            |     |       |
|------------------|-------------------------|------------|-----|-------|
| REV.             | DESCRIPTION             | DATE       | ECO | BY    |
| A                | RELEASED FOR PRODUCTION | 12/22/2020 |     | adold |

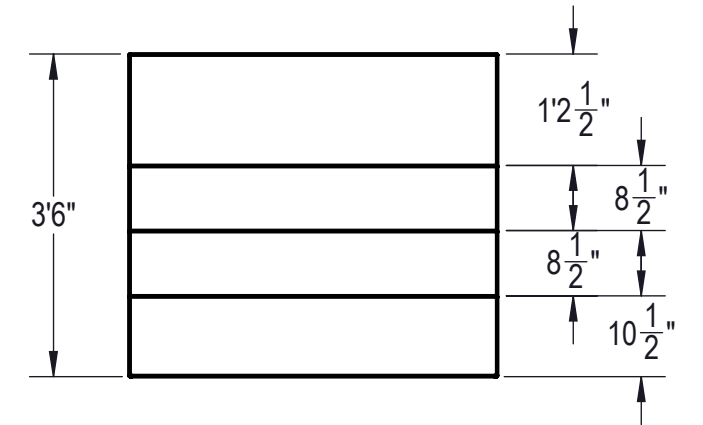
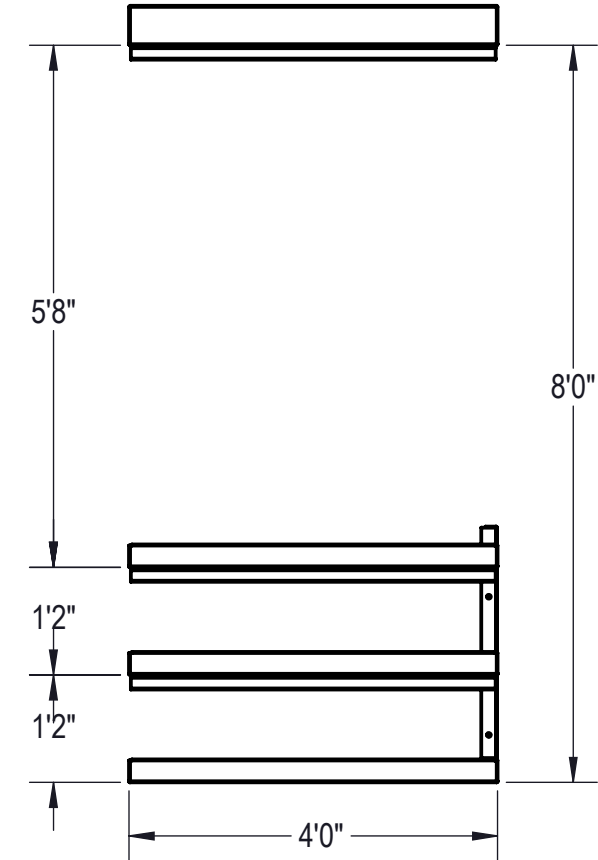
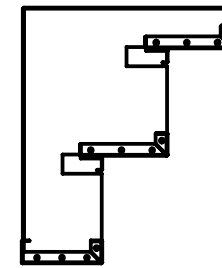
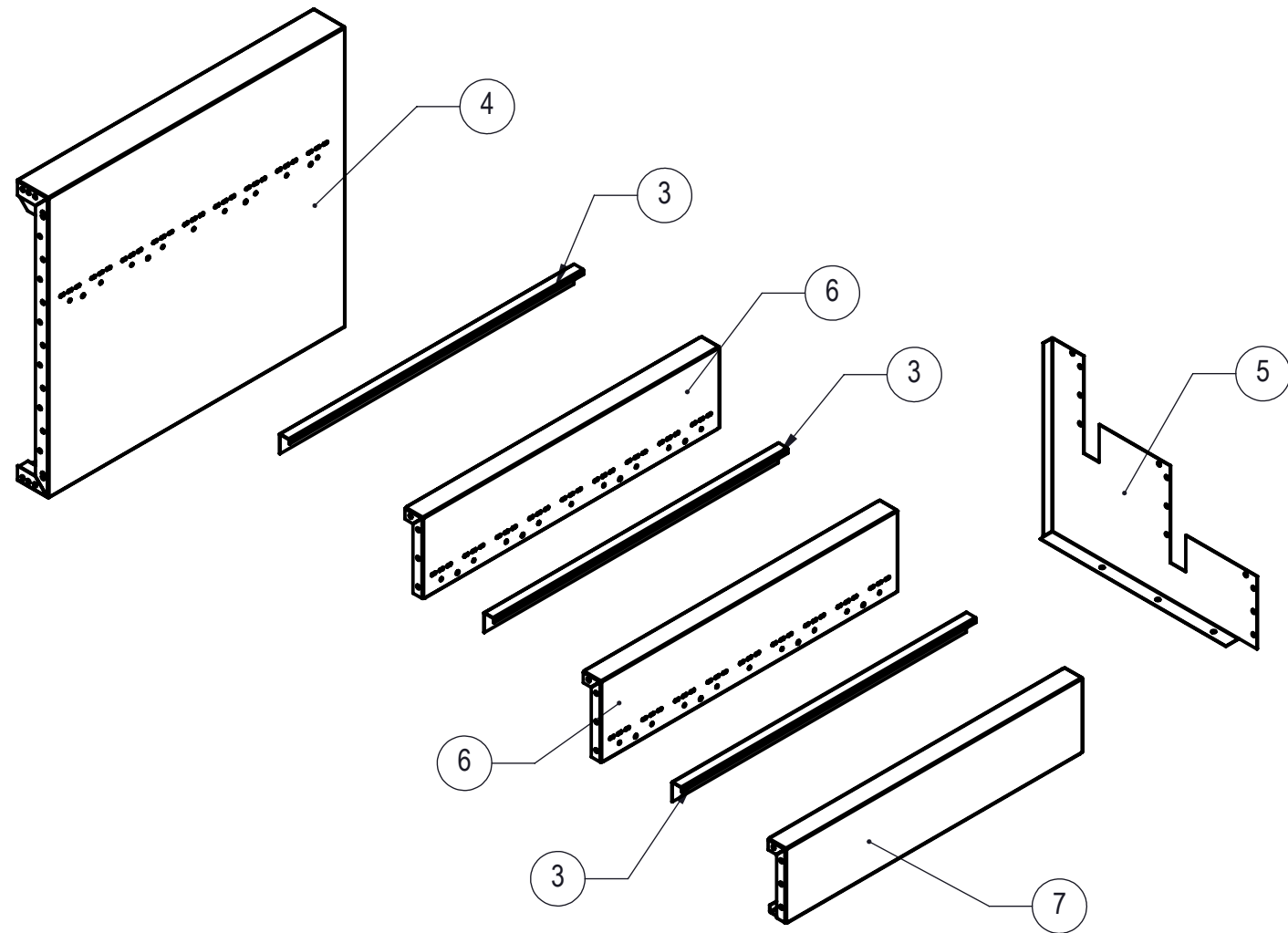

**NOTES:**

- THESE ARE FINISHED DIMENSIONS READY FOR THE LINER.
- DIMENSIONS ARE FROM INSIDE POOL PANELS.
- ROPE AND FLOAT ASSEMBLY SHOULD BE INSTALLED IN ACCORDANCE WITH CURRENT ANSI/ASPS/ICC REGULATIONS
- HYDRA LINER TRACK FOR STEPS IS INSTALLED WITH THE BARB FACING THE RISER WALL ON THE STEP.

**EXCAVATION NOTES:**

- ROUGH EXCAVATION SHOULD BE 2" DEEPER IN EACH INSTANCE.
- SOIL TO HAVE MINIMUM BEARING CAPACITY OF 1500 PSF.
- LOCATE TOP OF POOL AT LEAST 6" ABOVE THE SURROUNDING LAND ELEVATION.
- SEE "OVER DIG DETAIL", IN INSTALLATION MANUAL, FOR EXCAVATION AROUND POOL.
- FILL VOIDS UNDER BASE OF PANELS AND TAMP WELL.
- BACK FILL WITH NON-EXPANSIVE MATERIAL.
- FOLLOW ALL CURRENT ANSI / APSP / ICC GUIDELINES FOR RESIDENTIAL POOLS

**IMPORTANT NOTES:**

THIS DOCUMENT IS FOR ILLUSTRATIVE PURPOSES ONLY. THE DEALER OR CONTRACTOR WHO SELLS OR INSTALLS YOUR POOL IS AN INDEPENDENT CONTRACTOR AND IS NOT AN AGENT OF THE MANUFACTURER. THE CONSTRUCTION METHODS ILLUSTRATED HERE ARE SUGGESTIONS AND APPLY ONLY TO NORMAL GROUND CONDITIONS. THERE MAY BE ADDITIONAL PRECAUTIONS AND/OR METHODS OF CONSTRUCTION. PROPER INSTALLATION IS THE RESPONSIBILITY OF THE DEALER/BUILDER/CONTRACTOR.

| ITEM | FILE NAME  | DESCRIPTION   | CUSTOMER DRAWING # | VENDOR PART # | QTY. |
|------|------------|---|--------------------|---------------|------|
| 1    | BOLT, PACK | BOLT, FLANGE, 3/8-16 X 1", PACK (50)                            | HPS1916            | HPS1916       | 2    |
| 2    | SBRACE     | BRACE, FOLD OVER WITH TURNBUCKLE, STEEL, HPSFOB                 | HPSFOB             | HPSFOB        | 1    |
| 3    | 00017122   | LINER TRACK, OPEN POUR  | 00017122           | 00017122      | 3    |
| 4    | 00034441   | PANEL BACK, 4' LONG, 4 TREAD, OPEN POUR, TANNING LEDGE ASSEMBLY | 00034441           | 00034418      | 1    |
| 5    | 00034413   | SUPPORT, CENTER, 4 TREAD, OPEN POUR                             | 00034413           | 00034413      | 1    |
| 6    | 00034411   | TREAD, STEP, 4 TREAD, OPEN POUR, "B", 4'                        | 00034411           | 00034411      | 2    |
| 7    | 00034412   | TREAD, STEP, 4 TREAD, OPEN POUR, "C", 4' LONG                   | 00034412           | 00034412      | 1    |

|   |                              |   |                                  |                                       |   |
|---|------------------------------|---|----------------------------------|---------------------------------------|---|
| ENGINEERING DRAWING NUMBER<br><b>00034420</b> | WEIGHT:<br>lbs               | <b>UNLESS OTHERWISE SPECIFIED</b><br>DIMENSIONS ARE IN INCHES<br>TOLERANCES<br>DECIMALS: X ±<br>XX ±<br>XXX ±<br>XXXX ±<br><br>ANGULAR: X ± 0.5<br>THIRD ANGLE PROJECTION | DESIGNED BY:<br><b>ADOLD</b>     | CREATION DATE:<br><b>1/9/2018</b>     | <b>SAMSON STEEL</b>   |
|   | VOLUME:<br>Inch <sup>3</sup> |   | DETAILED BY:<br><b>adold</b>     | DETAILED DATE:<br><b>1/25/2021</b>    |   |
|   | COLOR:<br>NA                 |   | LAST REVISED BY:<br><b>adold</b> | LAST REVISED DATE:<br><b>1/8/2021</b> |   |
|   | HEAT TREAT:<br>NA            |   | MATERIAL:                        |                                       |   |
| FINISH:<br>NA                                 |                              |   |                                  |                                       | TITLE: <b>STEP, CORNER TOP TREAD, 4' X 8', 6" RADIUS, 4 TREAD, 4' SECTION, OPEN POUR, TANNING LEDGE, SUB ASSEMBLY</b> |
| TEXTURE:<br>576                               |                              |   |                                  |                                       | PART NUMBER:<br><b>HSSM34420</b>  |
|   |                              |   |                                  |                                       | SCALE: 1:32<br>SHEET: 3 OF 4<br>SIZE: <b>B</b>  |

CHECK IN DATE/TIME: Friday, January 08, 2021 11:02:51 AM

| REVISION HISTORY |                         |          |     |      |
|------------------|-------------------------|----------|-----|------|
| REV.             | DESCRIPTION             | DATE     | ECO | BY   |
| A                | RELEASED FOR PRODUCTION | 1/5/2021 |     | adol |

CHECK IN DATE/TIME: Monday, August 25, 2021 8:50:17 AM

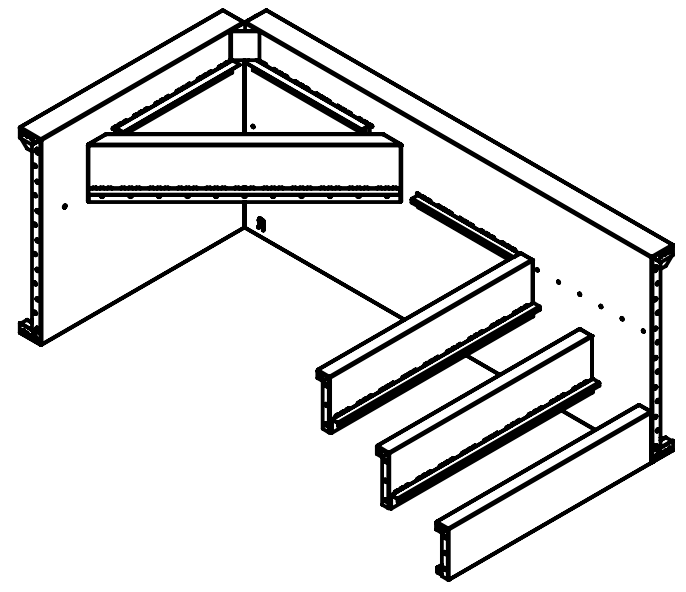
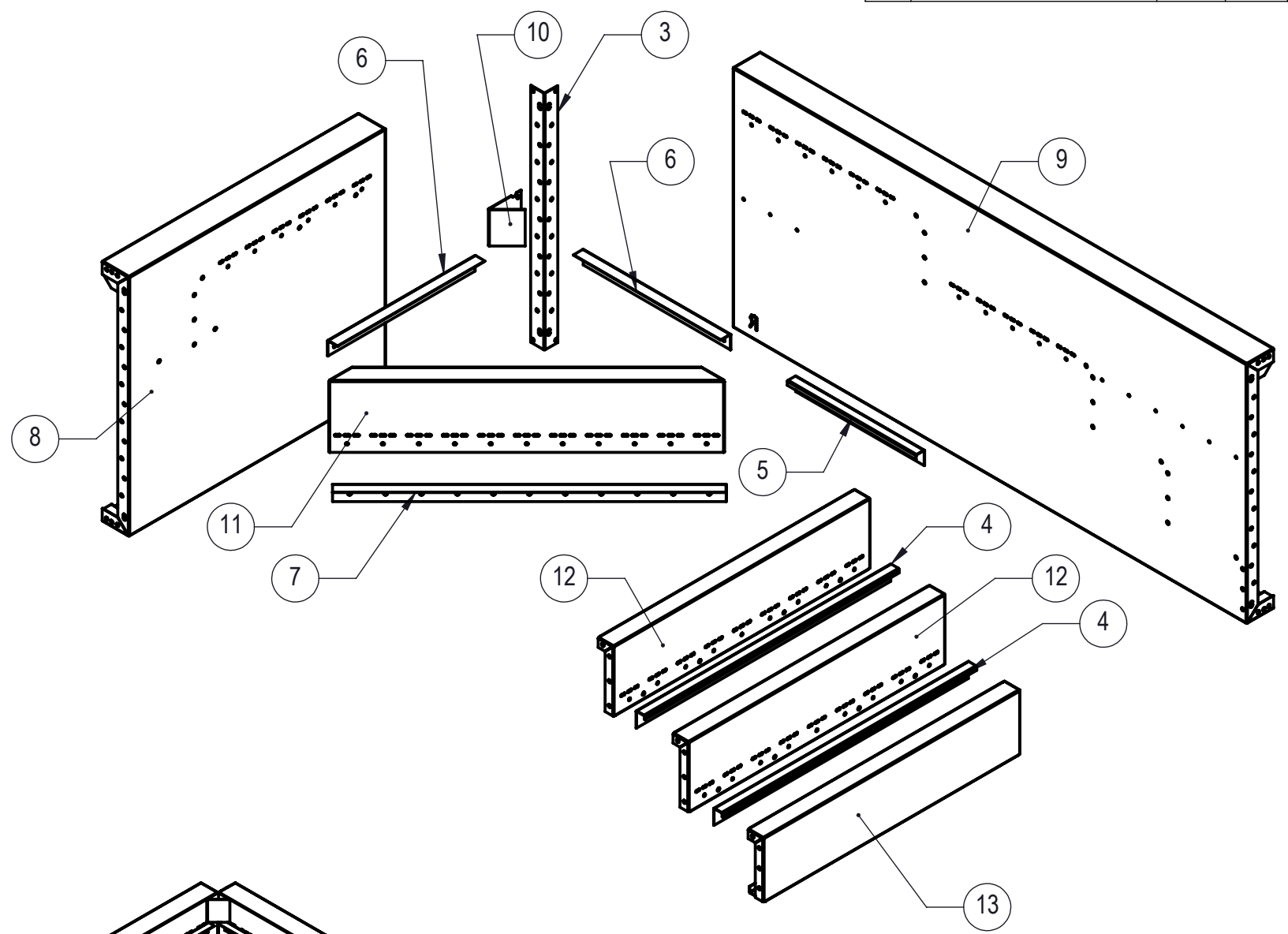
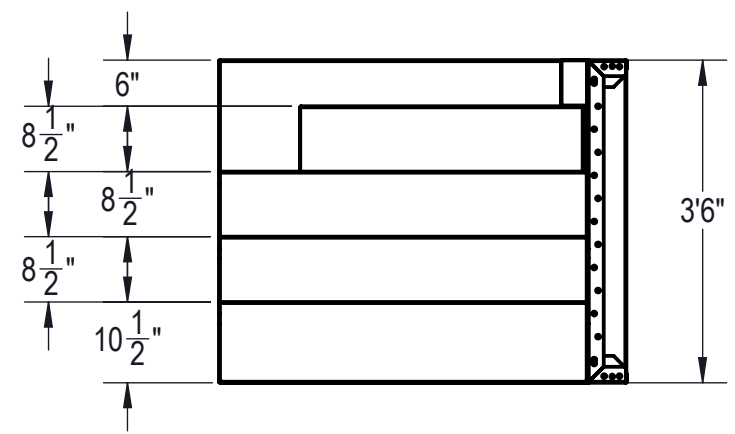
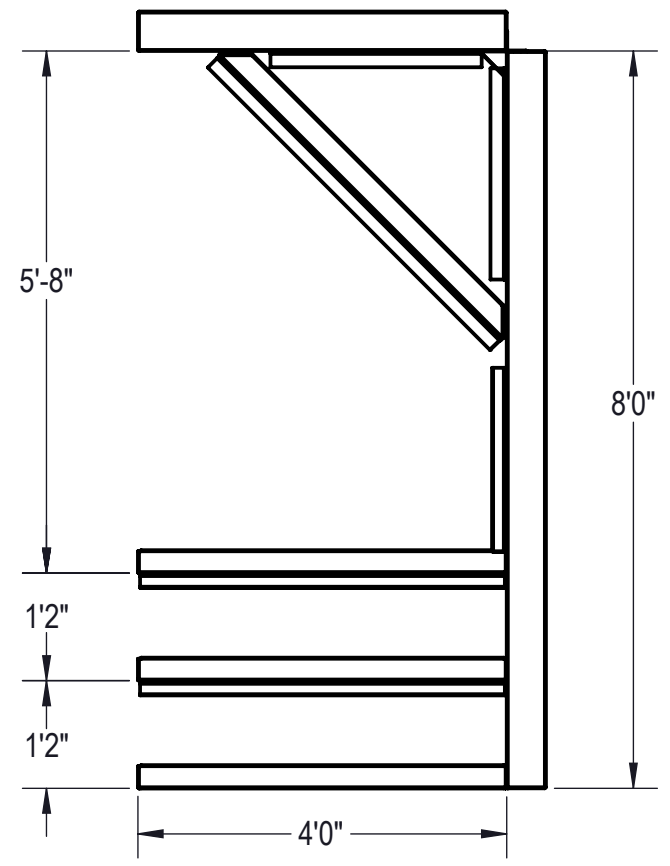
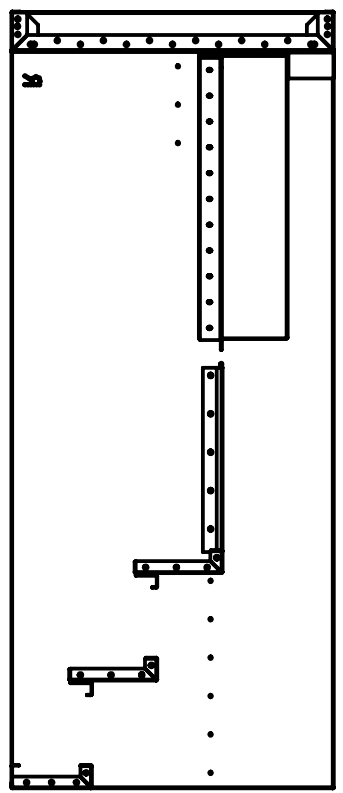

**NOTES:**

- THESE ARE FINISHED DIMENSIONS READY FOR THE LINER.
- DIMENSIONS ARE FROM INSIDE POOL PANELS.
- ROPE AND FLOAT ASSEMBLY SHOULD BE INSTALLED IN ACCORDANCE WITH CURRENT ANSI/ASPS/ICC REGULATIONS
- HYDRA LINER TRACK FOR STEPS IS INSTALLED WITH THE BARB FACING THE RISER WALL ON THE STEP.

**EXCAVATION NOTES:**

- ROUGH EXCAVATION SHOULD BE 2" DEEPER IN EACH INSTANCE.
- SOIL TO HAVE MINIMUM BEARING CAPACITY OF 1500 PSF.
- LOCATE TOP OF POOL AT LEAST 6" ABOVE THE SURROUNDING LAND ELEVATION.
- SEE "OVER DIG DETAIL" FOR EXCAVATION AROUND POOL.
- FILL VOIDS UNDER BASE OF PANELS AND TAMP WELL.
- BACK FILL WITH NON-EXPANSIVE MATERIAL.
- FOLLOW ALL CURRENT ANSI / A/SPS / ICC GUIDELINES FOR RESIDENTIAL POOLS

**IMPORTANT NOTES:**

THIS DOCUMENT IS FOR ILLUSTRATIVE PURPOSES ONLY. THE DEALER OR CONTRACTOR WHO SELLS OR INSTALLS YOUR POOL IS AN INDEPENDENT CONTRACTOR AND IS NOT AN AGENT OF THE MANUFACTURER. THE CONSTRUCTION METHODS ILLUSTRATED HERE ARE SUGGESTIONS AND APPLY ONLY TO NORMAL GROUND CONDITIONS. THERE MAY BE ADDITIONAL PRECAUTIONS AND/OR METHODS OF CONSTRUCTION. PROPER INSTALLATION IS THE RESPONSIBILITY OF THE DEALER/BUILDER/CONTRACTOR.

| ITEM | FILE NAME  | DESCRIPTION  | CUSTOMER DRAWING # | VENDOR PART # | QTY. |
|------|------------|--|--------------------|---------------|------|
| 1    | BOLT, PACK | BOLT, FLANGE, 3/8-16 X 1", PACK (50)   | HPS1916            | HPS1916       | 2    |
| 2    | SBRACE     | BRACE, FOLD OVER WITH TURNBUCKLE, STEEL, HPSFOB                                | HPSFOB             | HPSFOB        | 1    |
| 3    | 00000051   | CONNECTOR, CORNER, 2 1/2" X 1 1/2" X 90°                                       | HPSD90C            | HPSD90C       | 1    |
| 4    | 00017122   | LINER TRACK, OPEN POUR   | 00017122           | 00017122      | 2    |
| 5    | 00034424   | LINER TRACK, RIGHT OR LEFT, 28"  | 00034434           | 00034434      | 1    |
| 6    | 00028268   | LINER TRACK, TREAD "A"   | 00028268           | 00028268      | 2    |
| 7    | 00028269   | LINER TRACK, TREAD "B"   | 00028269           | 00028269      | 1    |
| 8    | 00034503   | PANEL, BACK, RIGHT, 4' LONG, 4 TREAD, OPEN POUR, TANNING LEDGE, ASSEMBLY       | 00034503           | 00034503      | 1    |
| 9    | 00034501   | PANEL, STEP, 4 TREAD, CORNER BENCH, MID LEDGE, RIGHT SIDE, OPEN POUR, ASSEMBLY | 00034501           | 00028527      | 1    |
| 10   | 00010294   | STEP, 4 TREAD, 90 DEGREE, CORNER, 6" RADIUS FILLER, FITS 10289                 |                    |               | 1    |
| 11   | 00034425   | TREAD, STEP, 4 TREAD, CORNER, TREAD "A", OPEN POUR                             | 00034425           | 00034425      | 1    |
| 12   | 00034411   | TREAD, STEP, 4 TREAD, OPEN POUR, "B", 4"                                       | 00034411           | 00034411      | 2    |
| 13   | 00034412   | TREAD, STEP, 4 TREAD, OPEN POUR, "C", 4' LONG                                  | 00034412           | 00034412      | 1    |

|   |                              |  |                          |  |  |
|---|------------------------------|--|--------------------------|--|--|
| ENGINEERING DRAWING NUMBER<br><b>00034502</b> | WEIGHT:<br>lbs               | <b>UNLESS OTHERWISE SPECIFIED</b><br>DIMENSIONS ARE IN INCHES<br>TOLERANCES<br>DECIMALS: X ±<br>XX ±<br>XXX ±<br>XXXX ±<br>ANGLAR: X ± 0.5<br>THIRD ANGLE PROJECTION<br> | DESIGNED BY:<br>ADOLD    | CREATION DATE:<br>1/9/2018   | <b>SAMSON STEEL</b>                            |
|   | VOLUME:<br>Inch <sup>3</sup> |  | DETAILED BY:<br>adol     | DETAILED DATE:<br>1/25/2021  |  |
|   | COLOR:<br>NA                 |  | LAST REVISED BY:<br>adol | LAST REVISED DATE:<br>1/25/2021  |  |
|   | HEAT TREAT:<br>NA            |  | MATERIAL:                | TITLE:<br>STEP, CORNER TOP TREAD, 4' X 8', 6" RADIUS, 4 TREAD, RIGHT, OPEN POUR, TANNING LEDGE, SUB ASSEMBLY |  |
| FINISH:<br>NA                                 |                              |  |                          |  | PART NUMBER:<br><b>HSSM34502</b>               |
| TEXTURE:<br>576                               |                              |  |                          |  | SCALE: 1:32<br>SHEET: 4 OF 4<br>SIZE: <b>B</b> |