

SAUNA WARRANTY REGISTRATION CARD - SA7015/SA7016

1. This sauna has a 1-Year Warranty against defects in materials and workmanship. To receive the warranty, the card must be filled out completely and returned.
2. Please notify Blue Wave Products in advance of any sauna warranty claim prior to shipping the sauna back. Contact our warranty claim department at warranty@splashnetexpress.com.
3. If the warranty claim department determines that the item must be returned, it must be returned with a receipt showing date of purchase, purchase price, and the dealer from which the sauna was purchased. **No warranty claim will be honored without a receipt.**
4. The freight on the item when returned must be prepaid.
5. Warranty claims will only be resolved with the repair of the current product or shipment of a replacement product. NO REFUNDS will be given.
6. Improper installation, misuse or damages resulting from acts of nature will render this warranty null and void.
7. This warranty is in lieu of all other warranties expressed or implied and no responsibility is assumed for future damage due to misuse. This sauna is intended for INDOOR USE ONLY – outdoor installation of the sauna WILL VOID THE WARRANTY. We are not responsible for damage to the sauna due to improper installation or misuse. Additional actions that will void the warranty are: Use of lacquer or paints, placing sauna on non-approved surface, and outdoor applications.

To send in this warranty card: Fill out below, detach and mail to the following address:

BLUE WAVE PRODUCTS
 1745 Wallace Ave. Suite B
 St. Charles, IL 60174

Detach Here

Detach Here

SAUNA WARRANTY REGISTRATION FORM

Date Purchased: ____/____/____
 Name: _____
 Address: _____
 City/State/Zip: _____
 Phone: () _____ Email: _____
 Purchased from: _____
 Item Number: _____ Purchase Price: _____
 Serial Number: _____



OWNER'S MANUAL Valerian & Liberty Portable Far Infrared Ray (FIR) Sauna



Please read entire manual carefully before using sauna.
WARNING! Never Leave Sauna Unattended When Not in Use.

Ver. 0920

SA7015 / SA7016

Usage Precautions

- This sauna is not medical equipment and is not intended for medical purposes.
- Check with your doctor before using this sauna when pregnant or if under medical care.
- Stop using the Sauna immediately if you feel uncomfortable, dizzy, or sleepy.
- Do not plug in while folded for storage.
- Staying too long in the sauna can cause overheating.



It is highly recommended that you DO NOT use the sauna for over 30 minutes per day and DO NOT use it more than 3 times per week.



NOT recommended for use by anyone under 18 years of age.

DO NOT use the Sauna under any of the following Health Conditions:

- Any type of respiratory condition
 - Anyone with a heart condition
 - High or low blood pressure
 - Pregnancy
 - Any skin disease or disorders
 - After or during drinking alcohol or alcoholic beverages
- Check with your doctor regarding the use of this product.
- WARNING! (Please read carefully before using sauna)**
- Unplug the power cord after each use.
 - Do not use in or around water due to danger of electrical shock.
 - Keep the electrical cord away from heat sources.
 - Never operate the unit if the cord or plug has been damaged.
 - Do not pull on the electrical cord.
 - Any repair must be performed by manufacturer, its service agent or similarly qualified person.
 - Never use in wet or damp conditions!

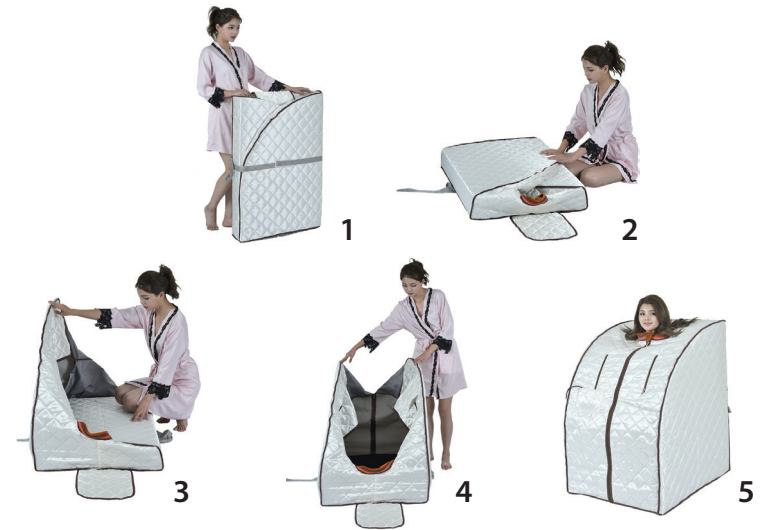

Using Your Sauna

1. Unfold the Sauna Box, connect the top & bottom support rods, put the cover on the bottom and place the folding chair inside the housing.
2. Plug the power cord into an electrical outlet.
3. Use the hand-held controller to set the time and temp.
4. We recommend pre-heating the Sauna Box for five minutes.
5. When the time and temperature has been set, it's recommended to drink a cup of water. Then sit in the Sauna, close the zipper and relax.
6. After using the Sauna, make sure to unplug the power cord.

Cleaning & Storage of Sauna

1. Dry any water from the Sauna box after using.
2. Open the zipper to ventilate. Wait until heat has dissipated to pack and store.
3. Use clean damp cloth to wipe off, and then fold.

Assembly Instructions - Sets Up in Minutes!

1. Unfold both side walls of the Sauna and stand upright.
2. Open the front zipper and place the floor cover on the floor over foot heater.
3. Unclip the bottom support rods and connect to help support the walls. *Note: you may connect the top support rods after getting in to make it easier to enter.* ▼
4. Place the Hand-Held Control in front pocket.
5. Put the folding chair on the rear part of the cushion facing forward.
The unit is now ready for use.
6. *When setting up or closing down, always keep away from sharp objects that may damage the unit.* Reverse set-up procedures when closing for storage.



Operating Hand-Held Control

1. Press Power key to turn on the controller. The TEMP will display 86° F (30° C) (default) while the TIME will display 45 minutes (default).
2. TEMP: Range 1-6: Approx. 86 – 167° F (30 – 75° C); Level 3, around 131° F (55° C), is a good moderate temperature; Level 6, around 167° F (75° C), is the highest and usually used in winter. Level 1 is lowest setting. Use the (▲) or (▼) keys to set the desired temperature range.
3. TIME: Range, 5 – 45 minutes. You will increase or decrease the time in 5 minute increments each time you press the (▲) or (▼) keys.
4. When there is no time remaining on your session, you will hear a beep to indicate such.
If you would like to continue with another session, repeat steps 1-3.



Hand-held controller

Functions & Features

- The side walls and back wall are covered with 0.1 mm ultra thin super conductive heating elements coated with heat activated FIR radiant material.
- When the FIR Sauna box heats up to 149° F (70° C), the FIR material will emit 95% of its energy.
- It takes only 5-10 minutes to reach 149° F (70° C) temperature.
- Low cost to operate.
- High heating efficiency. 760 W super conductive heating plus FIR radiation is equivalent to 1000 W thermal energy.
- Set up or take down in minutes. No mess to clean up, just wipe with a damp cloth.
- Light weight, only 18.7 lbs. (8.5 Kgs.)
- Dry and portable – suitable for use anywhere.
- Easily adjusts to your desired temperature with 86 – 167° F (30 – 75° C) temperature control.

FIR Sauna/Steam Sauna Comparison Chart

Item	Heating Type	Feature	Noise	Storage After Use	Assembly Time	Usage Location
FIR Sauna	Super Conductive Ultra Thin FIR Radiant Heat	Highly Efficient Heating Element Also On Your Feet	No Noise	Dry, No Odor, No Washing	1 min.	Living Rm. Bedroom
Steam Sauna Box	Regular Steam Sauna	No Extra Function for Feet	Noisy	Humid, Fungi, Odor, Needs to be Washed	Over 15 min.	Bathroom

FIR Sauna Specifications

Model	SA7015 / SA7016
Input Voltage	AC110V 50HZ
Input Power	760W
Inside Temperature	86 – 167° F (30 – 75° C) Temperature Control
Safety Device	Overheating Temperature Control
Timer	5 – 45 min.
Usage Size	32.3" (82cm)L x 26.8" (68cm)W x 39.4" (100cm)H
Storage Size	27.5" (70cm)L x 9" (23cm)W x 39.4" (100cm)H
Weight	18.7 lbs. (8.5 kgs)
Power Consumption	Low
Foot Heating Pad	Auto Temperature Control

Parts List - SA7015 / SA7016

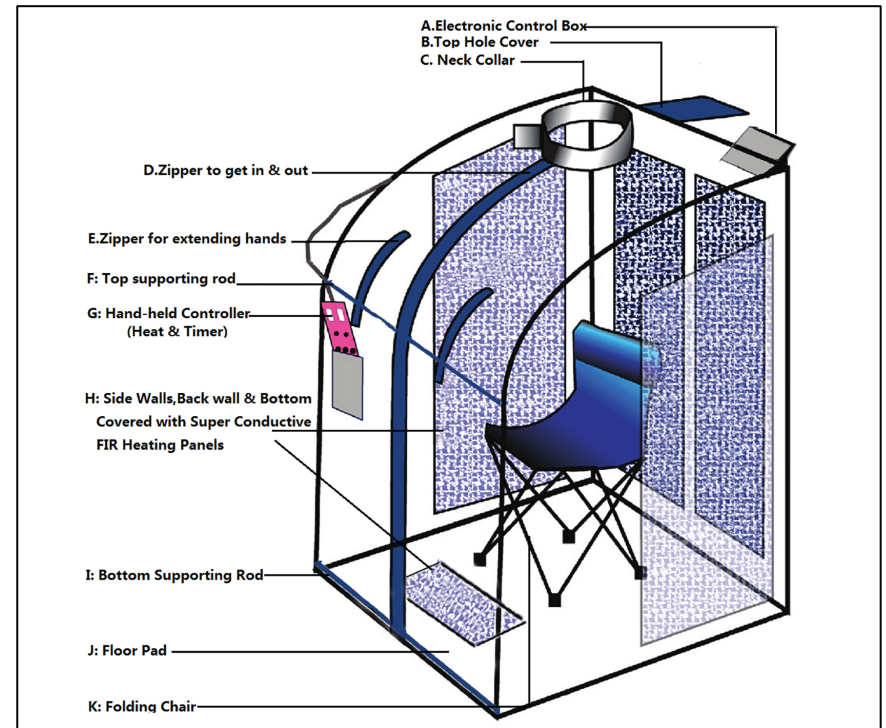

- A – Electronic Control Box
- B – Top Hole Cover
- C – Neck Collar
- D – Zipper to Get In & Out
- E – Zipper for Extending Hands
- F – Top Supporting Rod
- G – Hand-held Controller (Heat & Timer), Part No. SAP7082
- H – Side Walls, Back Wall (2) & Floor Covered with Super Conductive FIR Heating Panels, Part No. SAP7083
- I – Bottom Supporting Rod
- J – Floor Pad, Part No. SAP7084
- K – Folding Chair, Part No. SAP7085

